



VENIERI
SPA

HIGH EFFICIENCY / **HE**

8.63C

9.63D 10.63D 7.63D

WHEEL LOADERS



STAGE 5

9.63D 7.63D

BUILDING, CONSTRUCTION
AND **INDUSTRY**



CINEMATISM 4K

Latest generation kinematics, completely redesigned to ensure maximum breakout force.



THE SAFETY AND THE OUR PRIORITY

The front axle integrates inside the automatic negative parking / brake for maximum safety in every operating situation.



PRE
FILTRATION
TO CYCLONE

AIR A LOT ALWAYS

Engine air filtration takes place via main cartridge, cartridge safety and cyclone pre-filtration.



ABSOLUTE SILENCE

The commitment of Venieri R&D on the noise front has allowed a further reduction of the noise pollution produced, dropping below 70 dB, a value certified with the previous models, thus guaranteeing maximum operating comfort for the operator.



VISTA BREATHTAKING

The new ROPS/FOPS II° Level certified cab guarantees 360° visibility, allowing total visual control on any installed equipment.



CLEAR FRESH

The new ventilation system guarantees maximum comfort for the operator. You can choose between automatic climate control or the air conditioner, thus obtaining the perfect temperature in the cabin.



100% COME DESIGN

Maximum attention from the Centre Venieri style in maintaining the "family feeling", despite the introduction of a Stage V engine with substantially larger dimensions than the previous Stage IIIB.



COME DASH CONTROL

With the color electronic dash control the operator will be able to easily manage the electronic transmission, available options and transmission pressure reading.



STAGE 5



MOTOR DEUTZ STAGE IN TIER 4f

New Deutz engine, compliant with the latest anti-pollution regulations with high torque already at low revs. Substantial increase in power up to 21% and torque up to 17% compared to previous models.



DOUBLE SPEED

DOUBLE ATTENTION AL SAVINGS

Fan with double cooling speed electrically controlled and hydraulically operated. Rotation speed based on conditions of work: reduced fuel consumption and low noise.



STABILITY TOTAL

All the new Venieri loaders are equipped with a supported oscillating rear axle from maintenance-free media.



COME GLOBAL

Being connected is no longer optional for us. Thanks to the Venieri Global integrated system, the (standard) new Venieri blades and your smartphone become one.

(Annual Venieri Global subscription included).NON



CHANGE MECHANICAL "SHIFT ON FLY"

2-speed mechanical gearbox, with variation of the mechanical ratio at speed and electronic shift management (Su 9.63D).

On VF 7.63D the gear changes are synchronized from standstill).



INTELLIGENT ADVANCE

Application-specific driving mode of equipment that requires the utmost oil flow combined with the possibility of low-speed transfers.

Transfer manageable both using the Venieri Dash Control or directly from the pedal, allowing with the latter, to the operator, full control of the vehicle and equipment, without ever disconnecting hands off the wheel.



AGILE PER VOCATION AND PER DESIGN

The particular design of the counterweight has been studied to obtain extremely high angles of attack, protect the LED road lights, guarantee maximum maneuverability in tight spaces and prevent the ground from attacking when operating off-road.

10.63D 8.63C

AGRICULTURAL PER VOCATION



PARALLEL KINEMATISM

Latest generation kinematics, which guarantees parallel with the forks along the entire range of motion of the arm.



THE SAFETY AND THE OUR PRIORITY

The front axle integrates inside the automatic negative parking brake for maximum safety in every operating situation.



PRE
FILTRATION
TO CYCLONE

AIR A LOT ALWAYS

Engine air filtration takes place via main cartridge, cartridge safety and cyclone pre-filtration.



ABSOLUTE SILENCE

The commitment of Venieri R&D on the noise front has allowed a further reduction of the noise pollution produced, dropping below 70 dB, a value certified with the previous models, thus guaranteeing maximum operating comfort for the operator.

360°



VISTA BREATHTAKING

The new ROPS/FOPS II° Level certified cab guarantees 360° visibility, allowing total visual control even if equipped with extended parallel boom.



CLEAR FRESH

The new ventilation system guarantees maximum comfort for the operator. You can choose between automatic climate control or the air conditioner, thus obtaining the perfect temperature in the cabin.



100% COME DESIGN

Maximum attention from the Centre Venieri style in maintaining the "family feeling", despite the introduction of a Stage V engine with substantially larger dimensions than the previous Stage IIIB.



COME DASH CONTROL

With the color Dash control the operator will be able to easily manage the electronic transmission, the available options and the pressure reading of the transmission.



STAGE 5



MOTOR DEUTZ STAGE IN TIER 4f

New Deutz engine, compliant with the latest anti-pollution regulations with high torque already at low revs. Substantial increase in power up to 21% and torque up to 17% compared to previous models.



CHANGE MECHANICAL "SHIFT ON FLY"

2-speed mechanical gearbox, with variation of the mechanical ratio at speed and electronic shift management (Su VF 10.63D. On VF 8.63C the gear change takes place synchronized from standstill).



STABILITY TOTAL

All new Venieri loaders are equipped with an oscillating rear axle supported by maintenance-free supports.

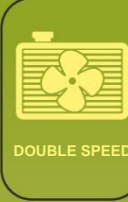

DOUBLE ATTENTION AL SAVINGS

Fan with double cooling speed electrically controlled and hydraulically operated. Rotation speed based on working conditions: reduced fuel consumption and low noise. "Reversible fan" kit available (optional)



TIRES PER APPLICATION

Wide range of agricultural tyres specific for each type of terrain and use, with different dimensions.



COME GLOBAL

Being connected is no longer optional for us. Thanks to the Venieri Global integrated system, the (standard) new Venieri shovels and your smartphone they become one. (Annual subscription Venieri Overall no included).



AGILE PER VOCATION AND PER DESIGN

The particular design of the counterweight has been studied to obtain extremely high angles of attack, protect the LED road lights, guarantee maximum maneuverability in tight spaces and prevent the ground from attacking when operating off-road.



INTELLIGENT ADVANCE

Equipment-specific driving mode that require high oil flow with transfers at low speed. Transfer manageable via Venieri Dash Control or from the pedal, allowing with the latter, full control of the vehicle and the equipment, without ever taking your hands off the wheel.

THE CABIN

A SIGHT BREATHTAKING.

Take a seat in your personalized control room. Create your environment optimal working position by adjusting the pneumatic seat and steering wheel according to your specific needs. Then select controls, all at your fingertips. The excellent **all-round visibility** where “blind spots” have been reduced to a minimum, gives you the optimum view to work with maximum efficiency, allowing total visual and operational control **over any installed equipment.**

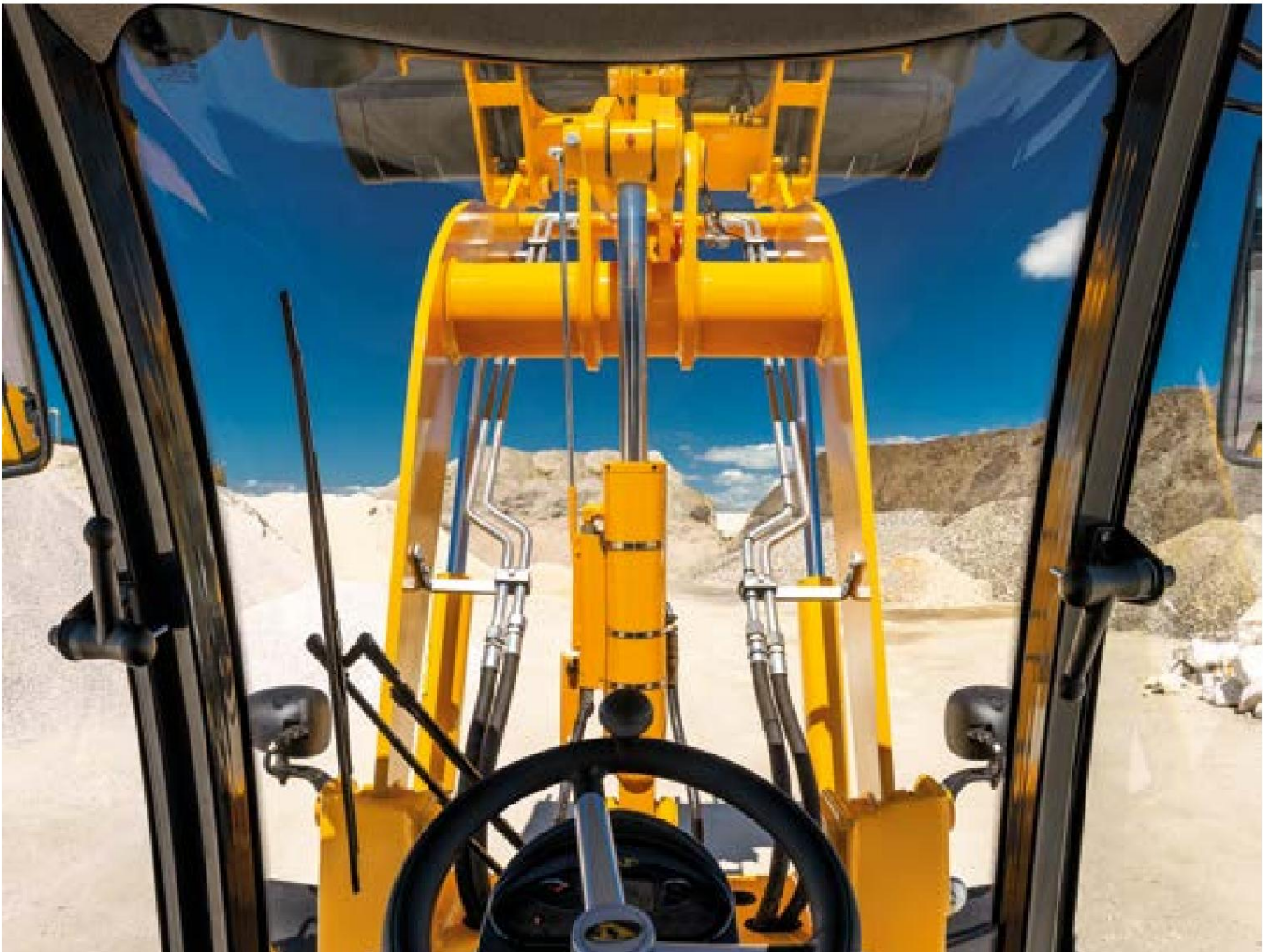

**BEAUTIFUL FRESH.
ALWAYS.**

The entire ventilation system (with **9 delivery points**) has been completely redesigned to align with ISO10263, also ensuring easy maintenance to the fully fold-down heating and A/C unit

to its housing.
Using a single dashboard, the operator can decide the ideal temperature, ensuring **maximum working comfort.**

All Venieri loaders can be equipped with **Climatronic Venieri** (optional): you set the temperature and...

he takes care of the rest!

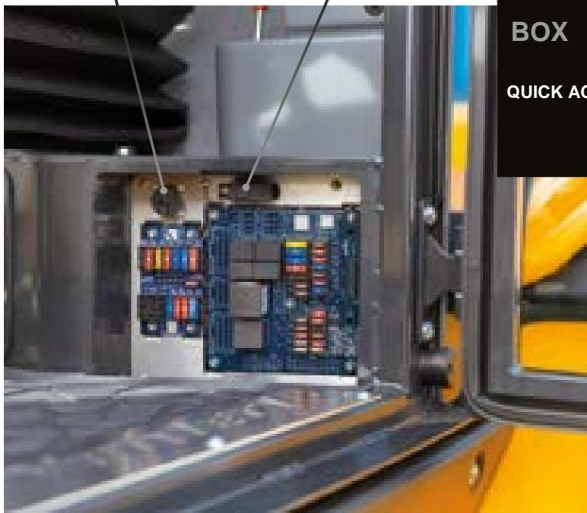
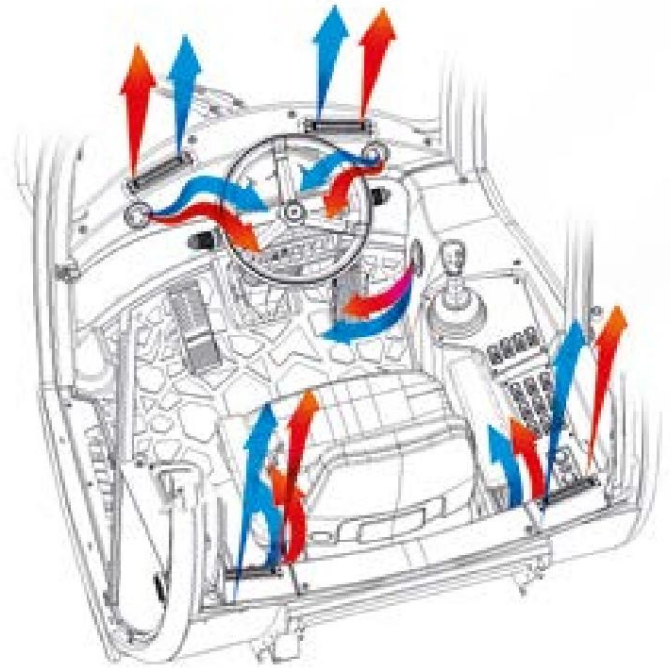

BOX
QUICK ACCESS BLACK

IT'S ALL HERE.

For the first time on a Venieri cab, all the electronic components have been placed in a **watertight chamber, made in the cab frame**, accessible only from inside the cab, easy to access and complete with all diagnostic sockets.

**OPEN
SESAME.**

The **double opening door** allows the operator to be able to work with the access door closed, but with the upper glass open, thus guaranteeing maximum ventilation even with the A/C system off and without having parts protruding out of shape.



THE BEAUTY NEVER ~~BEEN~~ SO FUNCTIONAL.

In designing the cab of the new wheel loaders, the Venieri Style Center has tried to blend **functionality and style**, with the ambition of making it one of the top on the market in terms of comfort and ergonomics.

The new interior design has also made it possible to create **various storage areas**, very useful for storing small work tools, mobile phones, drinks and more.

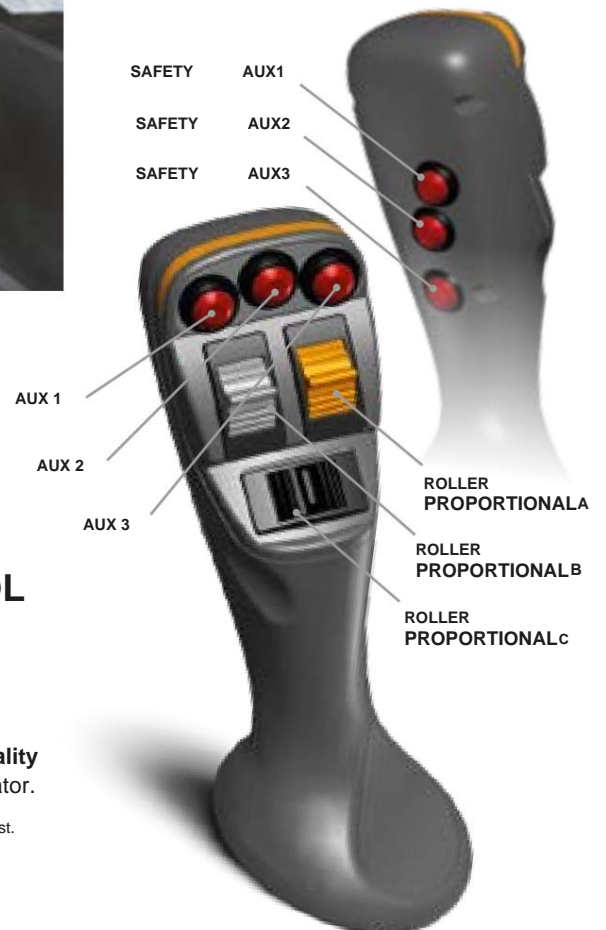

POWER AND CONTROL HANDY.

The mono-joystick* represents the best of all-in-one technology: **ergonomics and functionality** at the service of the operator.

* Optional, available a request.

THE TRANSMISSION

HE A NEW VISION OF HYDROSTATIC EFFICIENCY

The increasingly stringent limits for exhaust emissions will continue to pose an ever greater challenge to the further technical development of mobile working machines. In parallel with an ever greater efficiency and productivity required by the users of the machines themselves.

The **interconnection between the electronic and hydraulic parts** is vital in reducing **fuel consumption** and **exhaust emissions**, while at the same time increasing the **operational performance** of the machine.

The extraordinary evolution of electronics applied to hydraulic power therefore guarantees **greater flexibility** and a **targeted** response to deal more effectively **with every different operational requirement**.



SHIFT ON FLY. IT DOESN'T STOP A MOMENT.

Mobile machines to support the speeds required in road transport are generally equipped with hydrostatic transmission and a gearbox which can be of the **synchronized** or **automatic type**. In the first case the change from working gear to transfer is done from standstill, while in the second case the change takes place in progression.

(SoF = automatic)

The **Dana-Rexroth transmission** with **electronically controlled hydrostatic pump and motor** and an electronically controlled 367 SOF - **Shift On Fly gearbox** offers new opportunities for road driving, especially for wheel loaders.

Allows the operator to use at low speed with high traction forces, and then, during transfer, change the mechanical ratio in pairs, without stopping the machine, to reach a maximum speed of 40 km/h (self-limited)



- **GREATER EFFICIENCY:** HIGH FORCE FROM TRACTION AND MAXIMUM SPEED FROM TRANSFER
- **HIGH COMFORT:** YOU CHANGE FROM MARCIA QUICK AND SYNC WITHOUT INTERRUPTIONS
- **COMPONENTS** FROM SERIES AD VERY HIGH RELIABILITY
- **SATISFY** REQUIREMENTS FROM FUNCTIONAL SAFETY
- **COMPACT SIZE,** SPACE FROM INSTALLATION REDUCED

BENEFITS





MODE OF USE

There are 3 different driving modes available, each with different characteristics to ensure maximum operating efficiency at all times.



ECO



WORK



AUTOMOTIVE



MODE CHECK FROM

Essential when used with attachments, these modes allow you to adjust the machine's forward motion (by potentiometer or foot pedal) with all the hydraulic power available to the attachment.



POWER AND SPEED



CREEP



CREEP MODE PLUS



ELECTRONIC DASHBOARD

Control the main functions of the machine with a finger. Digital panel "DASH" necessary to select ALL the machine transmission modes and settings.



INTUITIVE CONTROLS



SIMPLICITY OF USE



REAL TIME DIAGNOSTICS

HIGH EFFICIENCY // HE





SAFETY A EDGE

Several safety controls operated by the Rexroth control unit, allow the operator to operate in total safety, with maximum efficiency and without the risk of machine downtime.



SELF-DIAGNOSIS

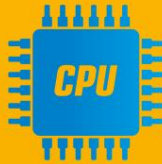

ELECTRONIC TRANSMISSION MANAGEMENT

It guarantees a distribution optimization of the available power to reduce consumption and increase performance.



INTELLIGENCE
ARTIFICIAL



INTERCONNECTED MACHINE

A totally interconnected machine controlled entirely in the cloud.

Welcome to the future.

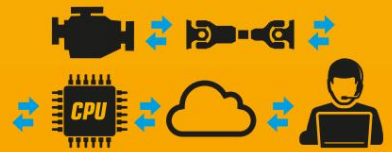

- PREDICTIVE MAINTENANCE
- REAL-TIME DATA & DIAGNOSIS
- SELF-LEARNING
- MACHINE IN THE CLOUD



VENIERI 4.0.

The VENIERI DASH CONTROL electronic Dashboard allows the operator to manage and display some of the most important functions of the machine with maximum ease and efficiency.

MODE

ECO

Control screen of the ECO mode, in which we have a "softer" transmission response curve setting and limitation on engine revs to max 1700 rpm



CONSUMPTION
INSTANT
AUTONOMY
RESIDUAL

CREEP PLUS



INTELLIGENT ADVANCE MODE

Screenshot of viewing and control of CREEP mode



LOAD
MOTOR
PRESSURE
TURBO

AUTOMOTIVE

Control screen of the AUTOMOTIVE mode, in which we have an average setting of the response curve of the transmission and all the engine revolutions available



LOAD
MOTOR

WORK

Control screen of the WORK mode, in which we have the inhibition of shifting, first gear from 15 km/h instead of 10 km/h and setting for the curve response of the more "aggressive" transmission



ERRORS
TRANSMISSION
PRESSURES
TRANSMISSION

DIAGNOSTICS

Control screen of diagnostic errors and pressures



MANUAL THROTTLE

Engine RPM display and control screen for use with attachments.

VENIERI
DASH
CONTROL



MACHINE 4 SEASONS.

The **multifunctionality** of the new blades is achieved with the single multifunction connection plate, an essential implementation to make them a universal tool carrier.



69dB INTERNAL

SILENCE IT'S THE VIRTUE OF THE FORTS.

The silence of the new shovel is simply extraordinary. With only **69dB** of internal noise in the cab you won't even notice you're at work, being able to also allow you to use very convenient options such as the Bluetooth™ hands-free kit with maximum effectiveness.

40 Km
TIMETABLES
SELF-LIMITED

VROOOOOOOOM!

Driving speed 40 km/h*, self-limited.

On the other hand, Venieri is based in the heart of the Italian Motor Valley and... the speed of the cars cannot be optional here!
*20 km/h the German version.

POWER AND EFFICIENCY. WHERE YOU NEED TO MORE.

Plenty of power for the hydraulic system and, at the same time, a reduction in travel speed.

For all this, the new Venieri wheel loaders need only one pedal. The brake pedal with function can control both mechanical and hydraulic brakes.

The obvious advantages are less wear on the service brake and optimum distribution of engine power.



Absence of pressure
on the inching/brake pedal:
maximum power for traction.



Normal pressure
on the inching/brake pedal:
speed reduction, more power in the service hydraulics.



Maximum pressure
on the inching/brake pedal:
the wheel loader stops,
maximum force for the hydraulic system.

THE MOTOR

MAXIMUM POWER, ECO FRIENDLY.

The engine that powers the new Venieri loaders is the DEUTZ TCD 3.6 L4, a compact in-line 4-cylinder water-cooled engine for industrial and agricultural machines, with a maximum power of 143 HP and aligned with EU Stage V and United States EPA Tier 4f requirements. Turbocharged engine with intercooler and exhaust gas recirculation, externally cooled. 100% power available at flywheel and front end.

Up to two hydraulic drives that can be mounted on a PTO with a total torque of up to 310 Nm.

TREATMENT OF THE GAS FROM UNLOAD

The exhaust gas management on this engine is **DOC/DPF + SCR**.
 DOC (Diesel Oxidation Catalyst) is a catalyst which reacts on contact with engine exhaust gases, transforming its main components into substances that are not harmful to the environment .
 The **DPF** (Diesel Particulate Filter), is a DEUTZ diesel particulate filter, coated with noble metals and adapted to the installation needs of the individual customer application, which supports regular, safe and continuous regeneration, without the need for regular maintenance or operating fluids additional. The use of reliable turbocharger technology, especially compared to exclusively SCR-based EAT systems, enables optimal engine performance across the entire rpm range. A surface temperature of max. 250°C provides additional safety during operation.

SCR (Selective Catalytic Reduction) is a method of reducing NOx emissions. The basis of this technology is a liquid 32.5% urea solution, which is sprayed into the exhaust pipe from a dedicated catalyst with a vanadium or zeolite coating. Urea produces ammonia (NH3) in a passive transformation which reacts with NOx and oxygen to form nitrogen and water.

- **MINIMUM CONSUMPTION** FROM LIQUIDS OPERATIVE RESPECT AT THE COMPETITION
- **INTERVAL** FROM MAINTENANCE BY 500 ORE PER REGENERATE I DEPOSITS FROM SULFUR AND THE CRYSTALLIZATION FROM ADBLUE
- **SUPPORT** TECHNICIAN AND DIAGNOSIS PROVIDED FROM THE NET WORLDWIDE ASSISTANCE FROM DEUTZ

BENEFITS

ADVANCED TECHNOLOGY PER THE RECOVERY GAS FROM UNLOAD

TECHNICAL OVERVIEW ON THE CONCEPT TIER 4 FINAL

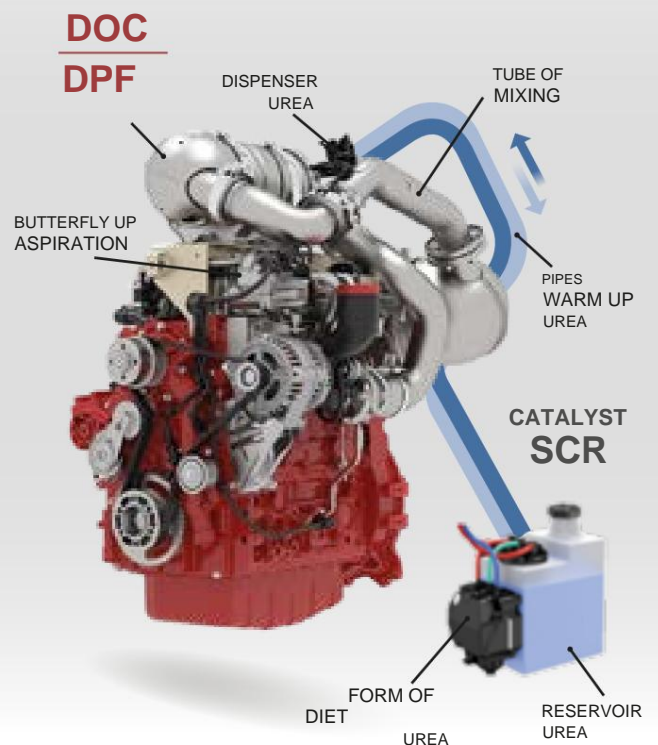

MANAGEMENT OF THE MOTOR

Engines equipped with DEUTZ Common Rail® injection communicate with the machine via a CAN-Bus protocol. This allows features such as drive-by-wire and full engine control to be integrated into electronically controlled hydrostatic thrusters. The automatic electronic control also guarantees the integrated engine diagnosis and safety system. If the controller registers an abnormal state of the motor, e.g. overheating, engine performance is reduced to limp mode until eventually shut down.

This minimizes costly repairs, reduces equipment downtime and increases operational reliability.

COMMON RAIL

The powerful Common Rail® injection system and the Electronic Engine Control (EMR) with intelligent connection to the engine management ensure optimal engine performance with low fuel consumption.

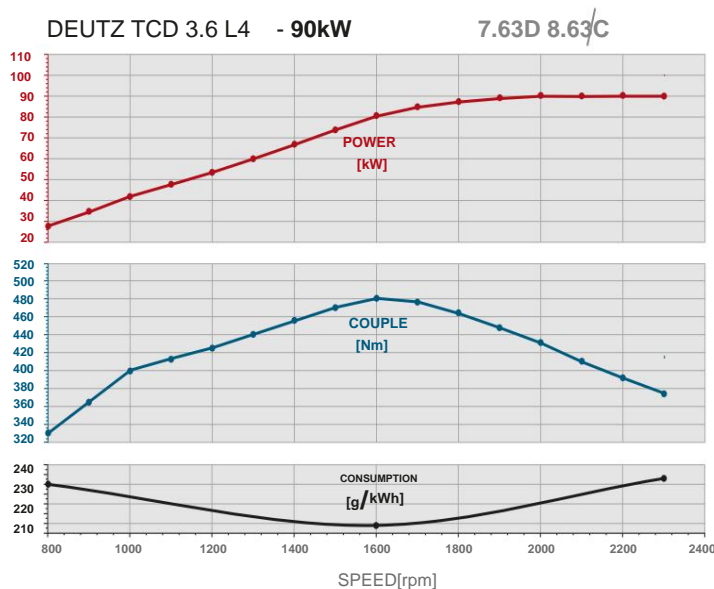
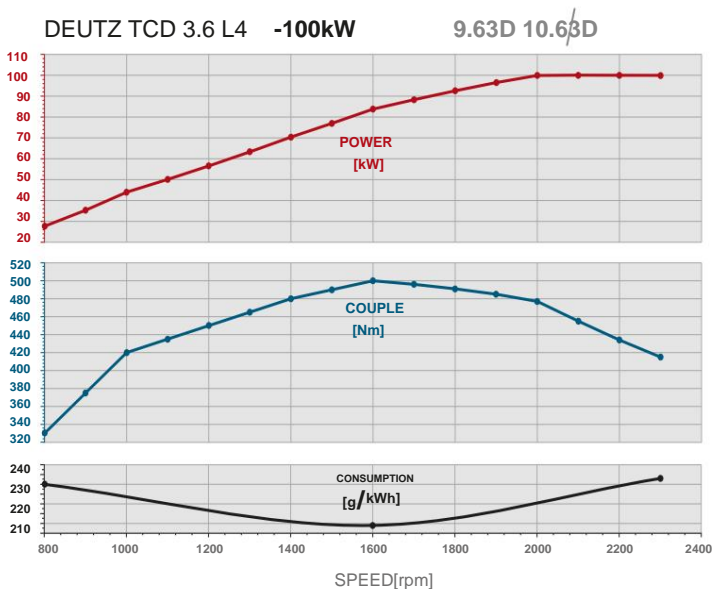

EVOLUTION IN PERFORMANCE

The step-up in performance guaranteed by the technological evolution of the brand new Deutz Stage V engine that equips the new Venieri loaders is evident in every area of use when compared to the previous generation of wheel loaders. And always with the utmost respect for the environment and consumption.



POWER

7.63C | 8.63B
7.63D | 8.63C
 9.63C | 10.63C
9.63D | 10.63D



eco mode



FUEL CONSUMPTION

7.63C | 8.63B
7.63D | 8.63C
 9.63C | 10.63C
9.63D | 10.63D



SPEED IN WORD

7.63C | 8.63B
7.63D | 8.63C
 9.63C | 10.63C
9.63D | 10.63D

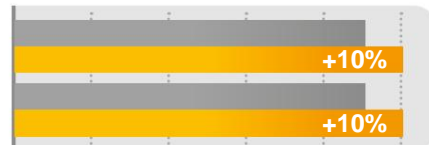

FORCE FROM NUMBER



7.63C | 8.63B
7.63D | 8.63C
 9.63C | 10.63C
9.63D | 10.63D



NOISE INTERNAL CABIN



7.63C | 8.63B
7.63D | 8.63C
 9.63C | 10.63C
9.63D | 10.63D

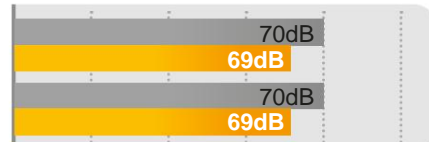

Venieri GLOBAL

CONTROLLA
LA TUA FLOTTA

Venieri GLOBAL™ is the brand new satellite monitoring system by providing detailed information on the incredible fleet of data to guarantee the highest performance levels and for

which allows to increase productivity, efficiency, quantities, higher economic a

F U N Z I O N I D I S P O N I B I L I

Machine localization	✓
Report history	✓
Maintenance planning	✓
Maintenance history	✓
Load information	✓
Operating hours history	✓
Protection against unauthorized use (engine block)	○
Total fuel consumption	✓
Fuel consumption in actual operating hours	✓
Machine efficiency (actual operating hours)	✓
Detailed history of operating hours	✓
Machine movement alarm	✓
Set curfew alarms	✓

Setting alarms for work shifts	✓
History of operating modes	○
Energy saving guide history	○
Position history (map with positions and operating modes)	✓
Particle filter information	✓
Work area control (geofence)	✓
Fleet tracking and management	✓
Multi-user management for access with specific policies	✓
Inactive Machine List (not running)	✓
SMS/email notification	✓
Audible alarm in case of theft	✓
Parameter programming on request	○

✓ Standard

○ Option ✗ Not available

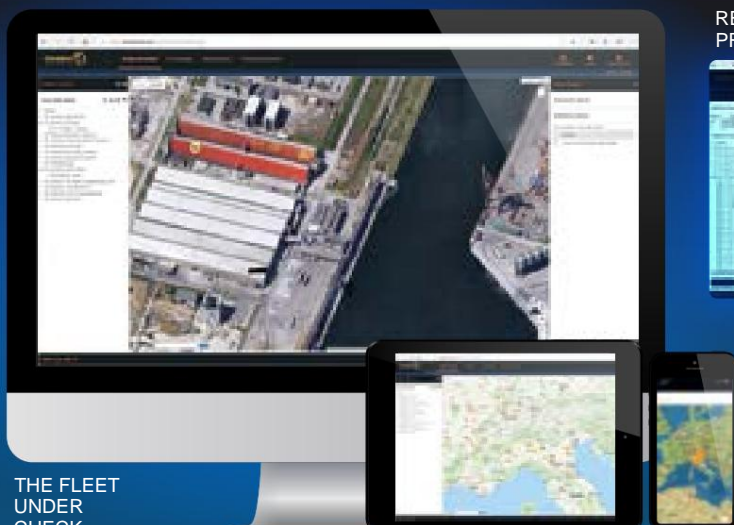

THE FLEET UNDER CHECK



APP PER SMARTPHONE
iOS™ E ANDROID™



MACHINE FITTINGS

Disconnect battery	✓	✓	✓	✓
Maintenance tool set	✓	✓	✓	✓
Diesel pre-heater for cold starting	0	0	0	0
Cap with key for fuel tank	✓	✓	✓	✓
Proportional limited slip differential on the front axle	✓	✓	✓	✓
Proportional limited slip differential on the rear axle	0	0	0	0
Differential with 100% locking on the front axle	0	0	0	0
Tow hook (Not homologated)	✓	✓	✓	✓
Rotating lamp	✓	✓	✓	✓
Soundproofing	✓	✓	✓	✓
Spare parts catalog	✓	✓	✓	✓
Use and maintenance manual	✓	✓	✓	✓
Approval for road traffic	✓	✓	✓	✓
Arm and bucket blocking safety device	✓	✓	✓	✓
Bucket positioning device parallel to the ground	✓	✓	✓	✓
CREEP mode	0	0	0	0
CREEP mode Plus	0	0	0	0
Venieri GLOBAL satellite monitoring (Annual subscription non included)	✓	✓	✓	✓
Double speed hydraulic fan	✓	✓	✓	✓
Reversible fan for radiator cleaning	0	0	0	0
Negative parking brake	✓	✓	✓	✓
Service brake on both bridges with separate circuits	✓	✓	✓	✓
Inch pedal integrated on the brake pedal	✓	✓	✓	✓
Grease points grouped on frames	✓	✓	✓	✓
Automatic centralized greasing	0	0	0	0
Ride control	0	0	0	0
Water preheating system	0	0	0	0
Hydraulic oil preheating system	0	0	0	0
Biodegradable hydraulic oil	0	0	0	0
ISO 46 hydraulic oil (cold climates) (On request in Italy)	✓	✓	✓	✓
Prefiltro vortex	✓	✓	✓	✓
Rear LED road lights	✓	✓	✓	✓
Electronically controlled hydrostatic transmission with 2 modes of use (Automotive e ECO)	✓	✓	X	X
Electronically controlled hydrostatic transmission with 3 modes of use (Automotive, Work e ECO)	X	X	✓	✓
Gearbox with 2 mechanical ratios and synchronizer (shift from standstill)	✓	✓	X	X
Gearbox with 2 mechanical ratios selectable on the go	X	X	✓	✓



FITTINGS CABIN

ROPS/FOPS II pressurized and soundproofed cab	✓	✓	✓	✓
Front and rear wiper with washer	✓	✓	✓	✓
Work lights (4 front + 2 rear) halogen	✓	✓	✓	✓
Working lights (4 front + 2 rear) LED	0	0	0	0
Cell phone compartment	✓	✓	✓	✓
Bottle holder	✓	✓	✓	✓
Document compartment	✓	✓	✓	✓
Seat with mechanical suspension	✓	✓	✓	✓
Seat with pneumatic suspension	0	0	0	0
Seat with air suspension and heating	0	0	0	0
Armrests on seat	✓	✓	✓	✓
Horn	✓	✓	✓	✓
Cabin carpet	✓	✓	✓	✓
Clothes hangers	✓	✓	✓	✓
Radio preparation	✓	✓	✓	✓
Additional 12V power socket	✓	✓	✓	✓
Manual air conditioning	0	0	✓	✓
"Climatronic Venieri" automatic air conditioning	0	0	0	0
Internal courtesy light	✓	✓	✓	✓
Sunblind	✓	✓	✓	✓
Rear view mirrors	✓	✓	✓	✓
Heated rear-view mirrors	0	0	0	0
First-aid kit	0	0	0	0
2 kg fire extinguisher	0	0	0	0
Security belt	✓	✓	✓	✓
Instrumentation and dashboard complete with LCD display	✓	✓	✓	✓
Venieri Dash Control	✓	✓	✓	✓
Glass breaker hammer	✓	✓	✓	✓



FITTINGS EQUIPMENT

Hydraulic or mechanical quick coupling	0	0	0	0
Mixing bucket	0	0	0	0
4 in 1 multipurpose bucket	0	0	0	0
Universal lifting forks	0	0	0	0
Asphalt/concrete cutter	0	0	0	0
Snow blower	0	0	0	0
Snow plow or plow blade	0	0	0	0
Lama livellatrice angle-tilt dozer	0	0	0	0
Hand demolition hammer	0	0	0	0
Rotating brush or sweeper	0	0	0	0
Trencher	0	0	0	0
Bucket with raised dump	0	0	0	0
High-flow plant	0	0	0	0
Free discharge	0	0	0	0
Double auxiliary system	0	0	0	0
Rear hydraulic outlets (single acting)	0	0	0	0

NOTE: trims vary from market. We indicate the way each trim is configured in base.
 ✓ Standard Or Optional X Not available

7.63D

CINEMATISM

A "WITH"

**MOTOR DIESEL**

4-cylinder in-line, supercharged, charge air cooling, electronically controlled common-rail injection, exhaust gas recirculation, water cooling, dry filtration, oxidation catalyst (DOC), particulate filter (DPF), selective catalytic reduction (SCR). Issued according to EC directive 97/68 - Stage V/Tier 4f.

Type	Deutz TCD 3.6 L4
max power	94.5 kW - 128 CV
Calibration (rpm)	2,300
ISO/TR 14396 power	90 kW - 122 CV
Power EEC 80/1269	90 kW - 122 CV
Maximum torque	Nm 480
Bore	mm 98
Race	mm 120
Displacement	cm³ 3.620

**ELECTRIC SYSTEM**

Drums	There were 12
Capacity	110Ah - 850A
Alternator	95 A
Reverse alarm	Standard
Wiring compliant with regulations	IP 67 - DIN 40050

**TRANSMISSION**

Hydrostatic with electronic power regulation and closed circuit with variable displacement pump and motor. 3 driving modes: Automotive, Eco and 2-speed mechanical gearbox with **synchroizer***. (change gear from standstill)

2 Working speed 1st gear km/h	Forward	Backwards
	0 ÷ 6	0 ÷ 6
2a marcia km/h	0 ÷ 13	0 ÷ 13
2 Travel speed Forward 1st gear km/h	Backwards	
	0 ÷ 18	0 ÷ 18
2a marcia km/h	0 ÷ 40**	0 ÷ 40**

* Optional, upon request. ** Maximum speed self-limited

**ASSAULT**

Same size heavy duty axles with planetary final drives on each wheel. Rigid front axle.

Oscillating rear axle with 25° excursion.

Distribution of the movement to the two front and rear axles by means of cardan shafts. Automatic limited slip differential on the front axle (optional are rear)

**BRAKING SYSTEM**

Service brake: hydraulic multi-disc oil bath on the front and rear axle.

Parking brake: negative hydraulic on the electrically operated front axle.

**TIRES**

Standard	15.5 x 25
----------	------------------

**PLANT**FROM **STEERING**

Servo-assisted steering by means of LOAD SENSING power steering.

Steering angle	80°
Internal tire turning radius	mm 2.703
Outside tire turning radius	mm 4.756
Outside Bucket Turn Radius*	mm 5.270

* in transfer position

**HYDRAULIC SYSTEM**

Consisting of two gear pumps, the first for the loader and steering circuit with LOAD SENSING valve, the second for the fan circuit, with double rotation speed. 2-section modular distributor with main valve.

Double effect jacks. Hydraulic oil cooler. Full flow filter on the return circuit.

Single lever servo for 4 position lift control and 3 position bucket control.

flow rate	lt/1' 105
Portata con kit high-flow (optional)	lt/1' 130
Loader calibration pressure	bar 250
Steering calibration pressure	bar 175
Lifting jacks	mm 85x827
Bucket jacks	mm 100x380
Lifting time (with load)	sec. 5.1
Lowering time (idle)	sec. 3.1
Unloading time	sec. 1.2
Total cycle time	sec. 9.4

**SUPPLIES**

Motor	lt 8
Front diff	lt 9,2
Rear diff	lt 9,1
Adapter	lt 1,8
Hydraulic circuit	lt 128
Brake circuit	lt 0,9
Fuel	lt 140
Water cooler	lt 20
AdBlue	lt 20

**TECHNICAL FEATURES**

Standard bucket capacity	m³ 1,4
Bucket width	mm 2.250
Static tipping load in line	kg 5.600
Static tipping load turned 40°	kg 5.000
Hydraulic lifting capacity at max. height	kg 5.600
Dump height at pin	mm 3.615mm (3.565)*
Dump height at 40°	2.890mm 845 (2.840)*
Discharge distance at 40°	kg 9.100 (895)*

Breakout force

* (...) With optional 405/70 R24 tyres

**DIMENSIONS AND WEIGHTS**

length max. on transfer	mm 5.900
Max. width in transfer	mm 2.250
External tire width	mm 2.117
Roadway	mm 1.710
Step	mm 2.560
Free light	mm 280 mm (230)*
Max height	2.938kg 7.860 (2.888)*
Standard operating weight	kg 8.750 (7.600)*
Maximum weight allowed	

* (...) With optional 405/70 R24 tyres

**dB LEVEL FROM NOISE**

Noise level in the cab ISO 6396 - LpA	dB(A) 69
External noise level ISO 6395 - LwA	dB(A) 101

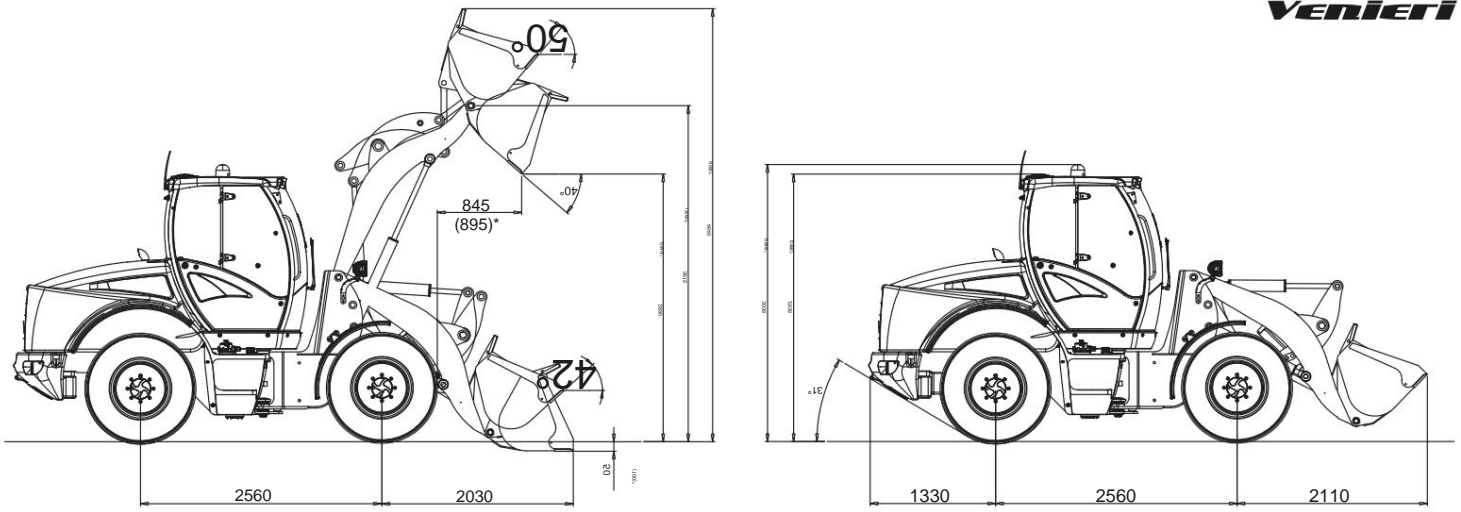

* (...) With optional 405/70 R24 tyres



DATA PERFORMANCE

STANDARD

MULTIPURPOSE

INCREASED

FORKS

Bucket capacity (SAE) heaped	m ³	1,4	1,1	2,0	/
Bucket width	mm	2.250	2.250	2.500	/
Bucket weight	kg	500	600	600	/
Max operating height	mm	4.645 (4.595)*	4.560 (4.510)*	4.560 (4.510)*	/
Fork length (standard)					1000
Fork length (optional)					1200
Unloading height at the pin	mm	3.615 (3.565)*	3.615 (3.565)*	3.615 (3.565)*	/
Relief angle	°	40°	40°	40°	/
Dump height	mm	2.890 (2.840)*	2.940 (2.890)*	2.840 (2.790)*	/
Discharge distance	mm	845 (895)*	795 (715)*	885 (805)*	/
Static tipping load in line	kg	5.600	5.700	5.400	/
Static tipping load - mach. swerve	kg	5.000	5.100	4.800	/
Fork tipping load - mach. swerve	kg				3.750
Operating load EN 474-3 (80%) [•]	kg				3.000
Operating load EN 474-3 (60%) [•]	kg				2.250
Breakout force	kg	9.100	10.100	8.600	/
Maximum length in transfer	mm	5.900	5.845	5.995	/
Outside turning radius of the bucket	mm	5.270	5.245	5.405	/
Standard operating weight	kg	7.860 (7.600)*	7.760 (7.500)*	7.960 (7.700)*	/

* (...) With optional 405/70 R24 tires [•] Load center at 500 mm

OPTIONAL TIRES

MORE COMMON | OTHERS They are REQUEST



15,5 R25
MICHELIN XTLA

L2 tire for multiple uses on different terrains with excellent traction force.

Machine width: 2,107 mm



15,5 x 25 CAMSO
LOADMASTER L3

Optimized tyre for all surfaces, with excellent resistance to side impacts and improved stability.

Machine width: 2.127 mm



405/70 R24
DUNLOP SPT9

Tire non-directional, multipurpose radial for industrial and construction applications.

Machine width: 2,217 mm



455/70 R24
DUNLOP SPT9

Tire non-directional, radial for building and industrial applications.

Machine width: 2,212 mm



440/80 R24
MICHELIN XCML

Agricultural tyre long lasting, outstanding traction and load capacity.

Machine width: 2,271 mm



15.5 R25 NOKIAN
LOADER GRIP 2

Tire for exceptional traction on soft ground or frozen.

Machine width: 2,104 mm

8.63C

CINEMATISMO PARALLELO



MOTOR DIESEL

4-cylinder in-line, supercharged, charge air cooling, electronically controlled common-rail injection, exhaust gas recirculation, water-cooled, dry filtration, oxidation catalyst (DOC), diesel particulate filter (DPF), selective catalytic reduction (SCR). Issued according to EC directive 97/68 - Stage V/Tier 4f.

Type	Deutz TCD 3.6 L4
max power	94.5 kW - 128 CV
Calibration (rpm)	2,300
ISO/TR 14396 power	90 kW - 122 CV
Power EEC 80/1269	90 kW - 122 CV
Maximum torque	Nm 480
Bore	mm 98
Race	mm 120
Displacement	cm³ 3.620



ELECTRIC SYSTEM

Drums	There were 12
Capacity	110Ah - 850A
Alternator	95 A
Reverse alarm	Standard
Wiring compliant with regulations	IP 67 - DIN 40050



TRANSMISSION

Hydrostatic with electronic power regulation and closed circuit with variable displacement pump and motor. 3 driving modes: Automotive, Eco and 2-speed mechanical gearbox with **SmartShift**®. (change gear from standstill)

2 Working speed 1st gear km/h	Forward	Backwards
gear km/h	0 ÷ 6	0 ÷ 6
2a marcia km/h	0 ÷ 13	0 ÷ 13

2 Travel speed Forward 1st gear km/h	Backwards
gear km/h	0 ÷ 18
2a marcia km/h	0 ÷ 40**

* Optional, on request. ** Self-limited maximum speed



ASSAULT

Same size heavy duty axles with planetary final drives on each wheel. Rigid front axle.

Oscillating rear axle with 25° excursion.

Distribution of the movement to the two front and rear axles by means of cardan shafts. Automatic limited slip differential on the front axle (optional are rear)



BRAKING SYSTEM

Service brake: hydraulic multi-disc oil bath on the front and rear axle.

Parking brake: negative hydraulic on the electrically operated front axle.



TIRES

Standard	460/70 R24
----------	-------------------



PLANT

FROM STEERING

Servo-assisted steering by means of LOAD SENSING power steering.

Steering angle	80°
Internal tire turning radius	mm 2.590
Outside tire turning radius	mm 4.870
Outside Bucket Turn Radius*	mm 5.350

* in transfer position



HYDRAULIC SYSTEM

Consisting of two gear pumps, the first for the loader and steering circuit with LOAD SENSING valve, the second for the fan circuit, with double rotation speed. 2-section modular distributor with main valve.

Double effect jacks. Hydraulic oil cooler. Full flow filter on the return circuit.

Single lever servo for 4 position lift control and 3 position bucket control.

flow rate	lt/1' 105
Portata con kit high-flow (optional)	lt/1' 130
Loader calibration pressure	bar 230
Steering calibration pressure	bar 175
Lifting jacks	mm 105x795
Bucket jacks	mm 80x680
Lifting time (with load)	sec. 5.4
Lowering time (unloaded)	sec. 3.9
Unloading time	sec. 1.8
Total cycle time	sec. 11.1



SUPPLIES

Motor	lt 8
Front diff	lt 9,2
Rear diff	lt 9,1
Adapter	lt 1,8
Hydraulic circuit	lt 128
Brake circuit	lt 0,9
Fuel	lt 140
Water cooler	lt 20
AdBlue	lt 20



TECHNICAL FEATURES

Standard bucket capacity	m³ 1,2
Bucket width	mm 2.250
Static tipping load in line	kg 5.150
Static tipping load turned 40°	kg 4.600
Hydraulic lifting capacity at max. height	kg 10.000
Dump height at pin	mm 3.775
Dump height at 40°	mm 2.970
Discharge distance at 40°	mm 1.055
Breakout force	kg 9.400



DIMENSIONS AND WEIGHTS

length max. on transfer	mm 6.180
Max. width on transfer	mm 2.250
External tire width	mm 2.230
Roadway Step	mm 1.770
Free light	mm 2.560
Max height	mm 250
Standard operating weight	mm 2.890
Maximum weight allowed	kg 8.200
	kg 8.750



dB LEVEL FROM NOISE

Noise level in the cab ISO 6396 - LpA	dB(A) 69
External noise level ISO 6395 - LwA	dB(A) 101

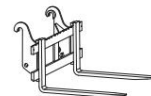
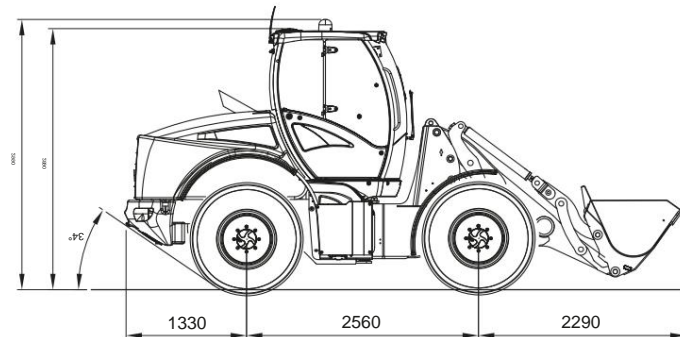
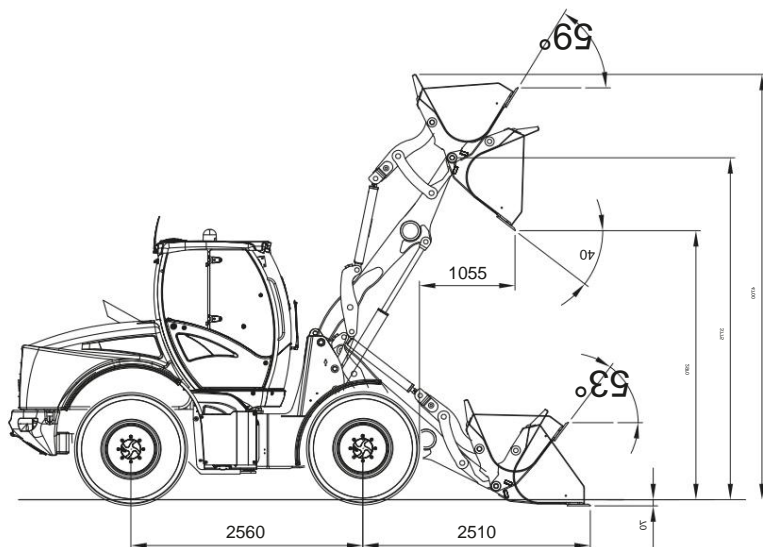

i DATA PERFORMANCE

STANDARD

MULTIPURPOSE

INCREASED

FORKS

Bucket capacity (SAE) heaped	m3	1,2	1,1	2,0	/
Bucket width	mm	2.250	2.350	2.500	/
Bucket weight	kg	450	550	600	/
Max operating height	mm	4.700	4.615	4.615	/
Fork length (standard)					1000
Fork length (optional)					1200
Unloading height at the pin	mm	3.775	3.775	3.775	/
Relief angle		40°	40°	40°	/
Dump height	mm	2.970	3020	2.920	/
Discharge distance	mm	1.055	1.005	1.095	/
Static tipping load in line	kg	5.150	5.050	4.950	/
Static tipping load - mach. swerve	kg	4.600	4.500	4.400	/
Fork tipping load - machinery swerve	kg				3.500
Operating load EN 474-3 (80%) [*]	kg				2.800
Operating load EN 474-3 (60%) [*]	kg				2.100
Breakout force	kg	9.400	10.400	8.900	/
Maximum length in transfer	mm	6.180	6.125	6.275	/
Outside turning radius of the bucket	mm	5.350	5.325	5.485	/
Standard operating weight	kg	8.200	8.300	8.350	/

[*] Load center at 500 mm

+ OPTIONAL TIRES

MORE COMMON | OTHERS They are REQUEST



**15,5 x 25
Mitas EM60**

L3 tire suitable for heavy duty with excellent self-cleaning properties.

Machine width: 2,104 mm



**405/70 THE MYTH
EM01 is MPT21**

Multi-purpose, non-directional tyre.

Machine width: 2,117 mm



**440/80 R24
MICHELIN XCML**

Long life agricultural tire with high traction and high load capacity.

Machine width: 2,211 mm



**500/70 R24
ALLIANCE A580**

Tire with an exclusive profile that guarantees strong traction, specific for soft surfaces.

Machine width: 2.275 mm

9.63D

CINEMATISM

A "WITH"

**MOTOR DIESEL**

4-cylinder in-line, supercharged, charge air cooling, electronically controlled common-rail injection, exhaust gas recirculation, water cooling, dry filtration, oxidation catalyst (DOC), particulate filter (DPF), selective catalytic reduction (SCR). Issued according to EC directive 97/68 - Stage V/Tier 4f.

Type	Deutz TCD 3.6 L4
max power	105 kW - 143 CV 2,300
Calibration (rpm)	
ISO/TR 14396 power	100 kW - 136 CV
Power EEC 80/1269	100 kW - 136 CV
Maximum torque	Nm 500
Bore	mm 98
Race	mm 120
Displacement	cm ³ 3.620

**ELECTRIC SYSTEM**

Drums	There were 12
Capacity	110Ah - 850A
Alternator	95 A
Reverse alarm	Standard
Wiring compliant with regulations	IP 67 - DIN 40050

**TRANSMISSION**

Hydrostatic with electronic power regulation and closed circuit with variable displacement pump and motor.
4 driving modes: Automotive, Work, Eco, Intelligent Advancement.
2-speed manual gearbox with mechanical speed ratio variation (Shift On Fly).

2 Working speed 1st	Forward	Backwards
gear km/h	0 ÷ 6	0 ÷ 6
2a marcia km/h	0 ÷ 16	0 ÷ 16

2 Travel speed Forward 1st gear km/h	Backwards
2a marcia km/h	0 ÷ 40**

* Optional, upon request. ** Maximum speed self-limited

**ASSAULT**

Same size heavy duty axles with planetary final drives on each wheel. Rigid front axle.

Oscillating rear axle with 25° excursion.

Distribution of the movement to the two front and rear axles by means of cardan shafts. Automatic limited slip differential on the front axle (optional are rear)

**BRAKING SYSTEM**

Service brake: hydraulic multi-disc oil bath on the front and rear axle.

Parking brake: negative hydraulic on the electrically operated front axle.

**TIRES**

Standard	17.5 x 25
----------	-----------

**PLANT**

FROM STEERING

Servo-assisted steering by means of LOAD SENSING power steering.

Steering angle	80°
Internal tire turning radius	mm 2.733
Outside tire turning radius	mm 4.908
Outside Bucket Turn Radius*	mm 5.406

* in transfer position

**HYDRAULIC SYSTEM**

Consisting of two gear pumps, the first for the loader and steering circuit with LOAD SENSING valve, the second for the fan circuit, with double rotation speed. 2-section modular distributor with main valve.

Double effect jacks. Hydraulic oil cooler. Full flow filter on the return circuit.

Single lever servo for 4 position lift control and 3 position bucket control.

flow rate	lt/1'	155
Loader calibration pressure	bar	230
Steering calibration pressure	bar	175
Lifting jacks	mm	100x815
Bucket jacks	mm	120x380
Lifting time (with load)	sec.	4.6
Lowering time (idle)	sec.	3.5
Unloading time	sec.	1.8
Total cycle time	sec.	9.9

**SUPPLIES**

Motor	lt	8
Front diff	lt	17,6
Rear diff	lt	11,9
Adapter	lt	1,8
Hydraulic circuit	lt	128
Brake circuit	lt	1,1
Fuel	lt	155
Water cooler	lt	20
AdBlue	lt	20

**TECHNICAL FEATURES**

Standard bucket capacity	m ³	1,8
Bucket width	mm	2.350
Static tipping load in line	kg	6.200
Static tipping load turned 40°	kg	5.500
Hydraulic lifting capacity at max. height	kg	6.900
Dump height at pin	mm	3.700
Dump height at 40°	mm	2.900
Discharge distance at 40°	mm	815
Breakout force	kg	8.600

**DIMENSIONS AND WEIGHTS**

length max. in transfer	mm	6.100
Max. width in transfer	mm	2.350
External tire width	mm	2.195
Roadway	mm	1.750
Step	mm	2.635
Free light	mm	380
Max height	mm	2.980
Standard operating weight	kg	9.000
Maximum weight allowed	kg	10.110

**dB LEVEL FROM NOISE**

Noise level in the cab ISO 6396 - LpA	dB(A)	69
External noise level ISO 6395 - LwA	dB(A)	99

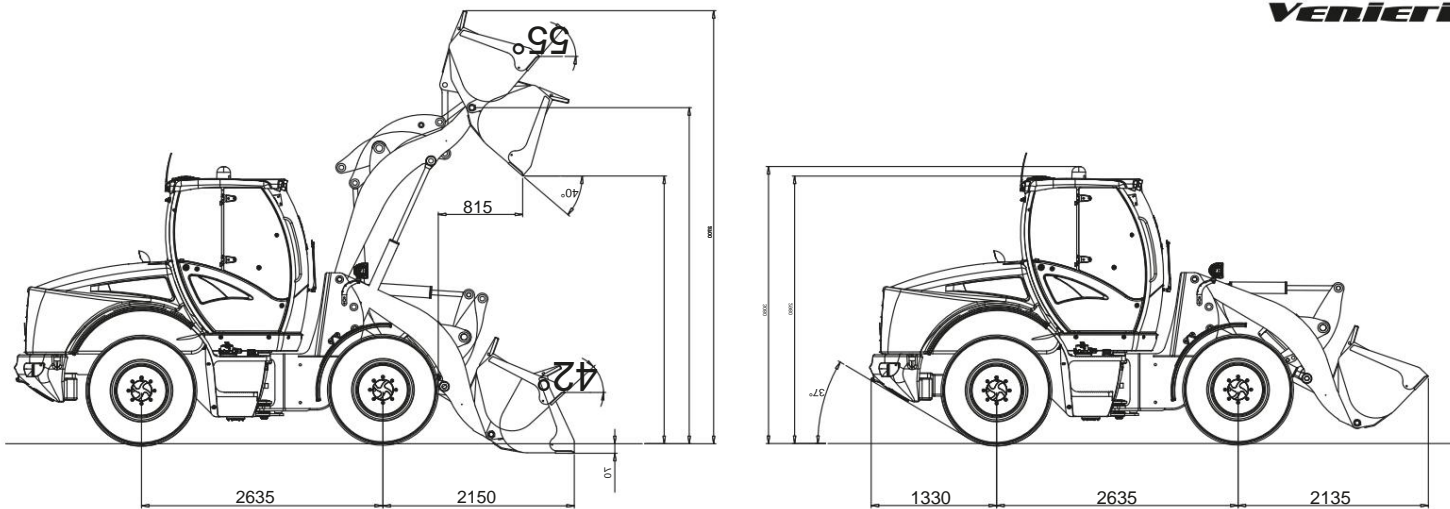

i DATA PERFORMANCE

STANDARD

MULTIPURPOSE

INCREASED

FORKS

Bucket capacity (SAE) heaped	m3	1,8	1,3	2,2	/
Bucket width	mm	2.350	2.350	2.500	/
Bucket weight	kg	650	750	750	/
Max operating height	mm	4.700	4.646	4.796	/
Fork length (standard)					1000
Fork length (optional)					1300
Unloading height at the pin	mm	3.700	3.700	3700	/
Relief angle		40°	40°	40°	/
Dump height	mm	2.900	2.950	2.833	/
Discharge distance	mm	815	800	924	/
Static tipping load in line	kg	6.200	6.300	6.000	/
Static tipping load - mach. swerve	kg	5.500	5.600	5.300	/
Fork tipping load - mach. swerve	kg				4.600
Operating load EN 474-3 (80%) [•]	kg				3.680
Operating load EN 474-3 (60%) [•]	kg				2.760
Breakout force	kg	8.600	9.600	7.800	/
Maximum length in transfer	mm	6.100	6.045	6.175	/
Outside turning radius of the bucket	mm	5.406	5.381	5.531	/
Standard operating weight	kg	9.000	9100	9.100	/

[•] Load center at 500 mm

0+ OPTIONAL TIRES

MORE COMMON | OTHERS They are REQUEST



**500/70 R24
MICHELIN XCML**

Long life agricultural tire with high traction and high load capacity.

Machine width: 2,351 mm



**15,5 R25
MICHELIN XTLA**

High traction multi-purpose L2 tyre.

Machine width: 2,209 mm



**15,5 x 25 CAMSO
LOADMASTER L3**

Optimized for multi-surface; high lateral impact resistance and improved stability.

Machine width: 2,127 mm



**17,5 R25 AEOLUS
A2233 L5**

L5 tire with cut and impact resistant compound. Very low risk of puncture. Tread pattern designed for exceptional traction and stability.

Machine width: 2.205 mm



**17,5 R25 MICHELIN
XMINE D2 L5**

Ideal tire for heavy loads, high strength and excellent traction/adhesion compromise.

Machine width: 2,240 mm



**17,5 R25
GRS OF NOKIA**

All-season tyre, ideal for winter conditions. Driving comfort is appreciable.

Machine width: 2,198 mm

10.63D

CINEMATISMO PARALLELO



MOTOR DIESEL

4-cylinder in-line, supercharged, charge air cooling, electronically controlled common-rail injection, exhaust gas recirculation, water cooling, dry filtration, oxidation catalyst (DOC), particulate filter (DPF), selective catalytic reduction (SCR). Issued according to EC directive 97/68 - Stage V/Tier 4f.

Type	Deutz TCD 3.6 L4
max power	105 kW - 143 CV 2,300
Calibration (rpm)	
ISO/TR 14396 power	100 kW - 136 CV
Power EEC 80/1269	100 kW - 136 CV
Maximum torque	Nm 500
Bore	mm 98
Race	mm 120
Displacement	cm3 3.620



ELECTRIC SYSTEM

Drums	There were 12
Capacity	110Ah - 850A
Alternator	95 A
Reverse alarm	Standard
Wiring compliant with regulations	IP 67 - DIN 40050



TRANSMISSION

Hydrostatic with electronic power regulation and closed circuit with variable displacement pump and motor.
4 driving modes: Automotive, Work, Eco, Intelligent Advancement.
2-speed manual gearbox with mechanical speed ratio variation (Shift On Fly).

2 Working speed 1st	After you	Backwards
gear km/h	0 ÷ 6	0 ÷ 6
2a marcia km/h	0 ÷ 16	0 ÷ 16

2 Transfer speed Forward 1st gear km/h	Backwards
	0 ÷ 14
2a marcia km/h	0 ÷ 40**

* Optional, on request. ** Self-limited maximum speed



ASSAULT

Same size heavy duty axles with planetary final drives on each wheel. Rigid front axle.

Oscillating rear axle with 25° excursion.

Distribution of the movement to the two front and rear axles by means of cardan shafts. Automatic limited slip differential on the front axle (optional are rear)



BRAKING SYSTEM

Service brake: hydraulic multi-disc oil bath on the front and rear axle.

Parking brake: negative hydraulic on the electrically operated front axle.



TIRES

Standard	17.5 x 25
----------	------------------



PLANT

FROM STEERING

Servo-assisted steering by means of LOAD SENSING power steering.

Steering angle	80°
Internal tire turning radius	mm 2.733
Outside tire turning radius	mm 4.908
Outside Bucket Turn Radius*	mm 5.600

* in transfer position



HYDRAULIC SYSTEM

Consisting of two gear pumps, the first for the loader and steering circuit with LOAD SENSING valve, the second for the fan circuit, with double rotation speed. 2-section modular distributor with master valve.

Double effect jacks. Hydraulic oil cooler. Full flow filter on the return circuit.

Single lever servo for 4 position lift control and 3 position bucket control.

flow rate	lt/1' 155
Loader calibration pressure	bar 230
Steering calibration pressure	bar 175
Lifting jacks	mm 105x770
Bucket jacks	mm 80x680
Lifting time (with load)	sec. 4.6
Lowering time (idle)	sec. 3.5
Unloading time	sec. 1.8
Total cycle time	sec. 9.9



SUPPLIES

Motor	lt 8
Front diff	lt 17,6
Rear diff	lt 11,9
Adapter	lt 1,8
Hydraulic circuit	lt 128
Brake circuit	lt 1,1
Fuel	lt 155
Water cooler	lt 20
AdBlue	lt 20



TECHNICAL FEATURES

Standard bucket capacity	m3 1,8
Bucket width	mm 2.350
Static tipping load in line	kg 5.800
Static tipping load turned 40°	kg 5.200
Hydraulic lifting capacity at max. height	kg 9.900
Dump height at pin	mm 3.800
Dump height at 40°	mm 2.850
Discharge distance at 40°	mm 1.100
Breakout force	kg 8.000



DIMENSIONS AND WEIGHTS

length max. in transfer	mm 6.230
Max. width in transfer	mm 2.350
External tire width	mm 2.195
Roadway	mm 1.750
Step	mm 2.635
Free light	mm 380
Max height	mm 2.980
Standard operating weight	kg 9.500
Maximum weight allowed	kg 10.110



dB LEVEL FROM NOISE

Noise level in the cab ISO 6396 - LpA	dB(A) 69
External noise level ISO 6395 - LwA	dB(A) 99

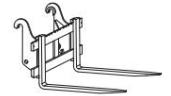
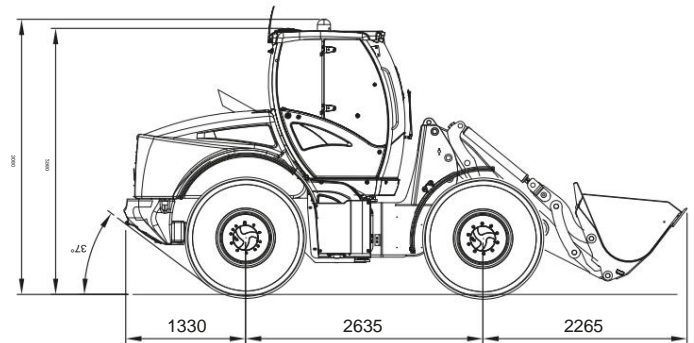
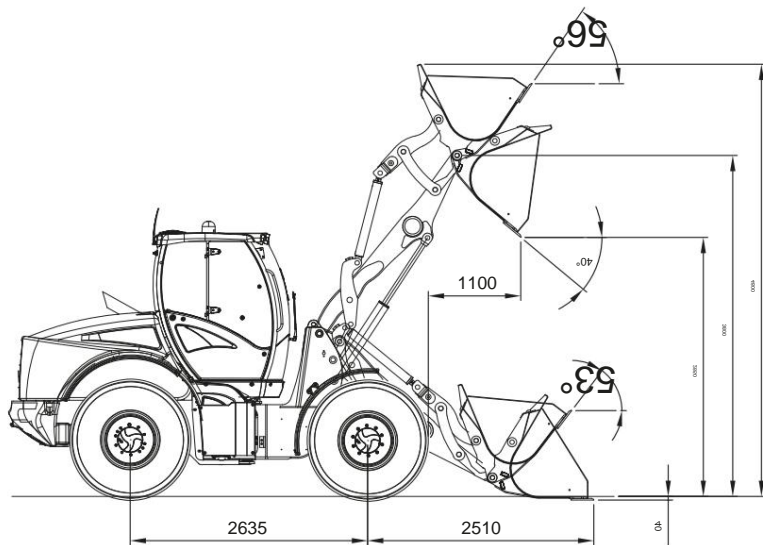

DATA PERFORMANCE

STANDARD

MULTIPURPOSE

INCREASED

FORKS

Bucket capacity (SAE) heaped	m ³	1,8	1,3	2,2	/
Bucket width	mm	2.350	2.350	2.500	/
Bucket weight	kg	650	750	750	/
Max operating height	mm	4.800	4.854	4.925	/
Fork length (standard)					1000
Fork length (optional)					1300
Unloading height at the pin	mm	3.800	3.800	3.800	/
Relief angle		40°	40°	40°	/
Dump height	mm	2.850	2.900	2.857	/
Discharge distance	mm	1.100	1.085	1.093	/
Static tipping load in line	kg	5.800	5.900	5.600	/
Static tipping load - mach. swerve	kg	5.200	5.300	4.900	/
Fork tipping load - mach. swerve	kg				4.200
Operating load EN 474-3 (80%) [•]	kg				3.400
Operating load EN 474-3 (60%) [•]	kg				2.500
Breakout force	kg	8.000	9.000	8.076	/
Maximum length in transfer	mm	6.230	6.175	6.305	/
Bucket external turning radius	mm	5.600	5.575	5.726	/
Standard operating weight	kg	6.500	9.600	9.600	/

[•] Load center at 500 mm

OPTIONAL TIRES

MORE COMMON | OTHERS They are REQUEST



17,5 x 25
Miitas EM60

500/70 R24
MICHELIN XCML

15,5 R25
MICHELIN XTLLA

15,5 x 25 CAMSO
LOADMASTER L3

17,5 R25 AEOLUS
A2233 L5

17,5 R25 MICHELIN
XMINE D2 L5

17,5 R25
GRS OF NOKIA

Tread designed for heavy use on construction sites and combines with excellent self-cleaning properties.

Long life agricultural tyre with high traction and high load capacity.

High traction multi-purpose L2 tyre.

Multi-surface optimized tyre; high lateral impact resistance and improved stability.

L5 tyre, cut and impact resistant compound. Minimal risk of puncture. Tread designed for exceptional traction and stability.

Ideal tire for heavy loads, high strength and excellent traction/adhesion compromise.

All-season tyre, ideal for winter conditions. Driving comfort is appreciable.

Machine width: 2,195 mm

Machine width: 2,351 mm

Machine width: 2,209 mm

Machine width: 2,127 mm

Machine width: 2,205 mm

Machine width: 2,240 mm

Machine width: 2,198 mm



www.vf-venieri.com



Venieri SPA
MACCHINE MOVIMENTO TERRA

Via Piratello, 106 - 48022 Lugo (RA) - ITALY Tel. +39 0545 904411 Fax +39 0545 30389

e-mail: info@vf-venieri.com | www.vf-venieri.com

SPARE PARTS SERVICE

Tel. +39 0545 904429 Fax +39 0545 24555

e-mail: ricambi@vf-venieri.com