



TM

**VENIERI**  
SPA

**2.63D**

*Plus*

WHEEL LOADER





# LITTLE BIG ONE.

REDUCED SIZE, UNSTOPPABLE POWER



## Increase your expectations: Venieri's small one is here!

Thanks to the widely tested project evolution matching the new market requirements, the new machine represent a significant improvement. We are located in the “**Motor Valley**” which, in a small territory, has always been giving birth to fabulous cars and top performing motorbikes!

The genetic heritage is very rich: the **Japanese technology** of the **Kubota engines**, **new Bosch Rexroth transmissions** and a **ratio traction/weight** never before achieved.

The **ORA** (oscillating rear axle) is one of the main organs in this series: **there isn't any oscillating mechanical coupling** between the front and rear, ensuring smart working and driving safety on this small one which can be normally found on big machines only.

*Plus*  
**2.63D**

- › “Z” Linkage
- › Max power **53 HP**
- › Bucket capacity **0,75 m<sup>3</sup>**
- › Max permis. weight **4.800 kg**
- › Std operat. weight **4.350 kg**

## ENGINE: JAPANESE TECHNOLOGY

The **Kubota D1803-CR-T-E5** engine complies with **Tier 4f - Stage V** strict regulations.

Advanced **particulate filter technology (DPF)** of the latest generation, enables an automatic regeneration even at low rpm and allows **appreciably maintenance intervals reductions** thus ensuring operational **continuity**.

**Quietness, durability and efficiency** are guaranteed by the **Common Rail** system capable to optimize combustion maximum efficiency. A clean, flexible engine with top performances.



## TRANSMISSION: GLOBAL QUALITY

There are many ways to transmit power but only one is able to satisfy even the most demanding customers: **Venieri** and **Bosch-Rexroth** laboratories have studied and developed **one of the best possible combinations of high pressure transmission** (so **high efficiency transmission with 500 bar\***). In that way the **efficiency** of Venieri's wheel loaders led to a **11% improvement**: try and you'll believe it!

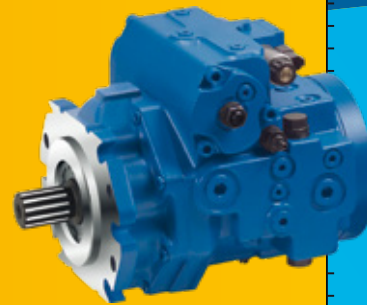

### Extended performance range

Tractive Force F [kN]

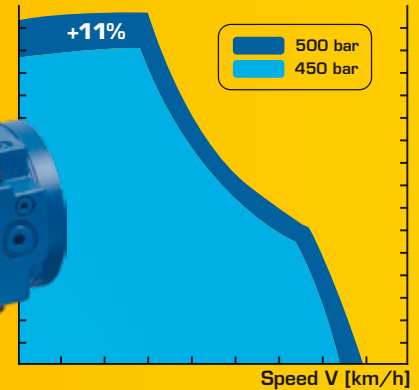

## AXLE: TOP LEVEL EQUIPMENT

The **double fixing** on each side grants **extreme reliability and stiffness to the chassis even after 8000/10000 working hours** and represents a further confirmation of our design philosophy: **small size machines equally designed as the big ones!** The **18° rear oscillation** grants perfect **stability and security** during working and transfer operations. Electrically driven 100% blocking slip differential.



## GREASING: CENTRALIZED COMFORT

**Maintenance** is fundamental on all machines: Venieri decided to build machines **easy and accessible to anyone**: machines whose maintenance operations can be carried out in an **easy and safe way**, thanks to its particular design. For example, the **3 points of centralized greasing** allow the **rear axle** and the **articulation** to be instantly double checked.





**80° articulation.**

Cramped conditions do not scare us.



**Steering console.**

A master piece for all job requirements!



**Arms Connection with ovalized section.**

We want to see clearly!



**Framed glass door and flat glass.**

We combine style with efficiency!



**Multipurpose Joystick.**

You can do everything with one hand!

**Hydraulic quick coupling.**

Use your Venieri as a universal tool carrier thanks to the interchangeability of most quick couplings/equipment!

**Linkage connection on the chassis with cantilevered pins.**

+ performance, better visibility = less risk!



**Evolved and complete hydraulic.**

Not only High Flow kit but also additional hydraulic kit for tools and equipments. An example? Hand operated hydraulic demolition hammer!



# 2.63D Plus

## WHEEL LOADER / "Z" LINKAGE



### DIESEL ENGINE

Engine: 3 cylinder in line engine, turbocharged, common-rail injection with electronic control, exhaust gas recirculation EGR, water cooled, dry filtration, diesel oxidation catalyst (DOC), diesel particulate filter (DPF). Emissioned according to CE 97/68 - Stage V/Tier 4f

Type	Kubota D1803-CR-T
Max Power	39kW - 53 HP
Rated rpm	2.700
Power ISO/TR 14396	37 kW - 50 HP
Power EEC/80/1269	35,3 kW - 47 HP
Max. torque	Nm 150,5
Bore	mm 87
Stroke	mm 102,4
Displacement	cm <sup>3</sup> 1.826



### ELECTRIC SYSTEM

Battery	12 Volt
Capacity EN 60095-1	80 Ah - 770 A
Alternator rating	60 A
Reverse warning	Standard
Wiring according to rules	IP 67 e DIN 40050



### TRANSMISSION

Hydrostatic transmission with automatic power regulation and closed circuit with variable-displacement pump and engine. Two forward/reverse speeds with single-lever control.

	forward	reverse
1 <sup>st</sup> Gear km/h	0÷9	0÷9
2 <sup>nd</sup> Gear km/h	0÷30/34*	0÷30/34*

(\* High speed optional.



### AXLES

All wheel drive. Two heavy duty axles with planetary final drives on each wheel. Fixed rigid drive axle on front chassis section. Oscillating drive axle on rear chassis section up to a 20° total angle. Transfer gearbox allowing the rear and the front movement by means of a transmission shaft. Self-locking limited slip differential on front axle (optional on rear axle).



### BRAKES

Service: drum-brake hydraulically operating on front axle working on all wheels. Parking brake: mechanical drum-brake operating on service brake, manually activated.



### TYRES

Standard	12.0/75-18 12pr
Optional	10.5-18 10pr • 12.5-18 10pr • 15.5/55 R18



### STEERING

Servo assisted hydraulic steering with LOAD SENSING system.

Total steering angle	80°
Inner tyres turning radius	mm 2.193
External tyres turning radius	mm 3.790
External bucket turning radius	mm 4.210



### HYDRAULIC SYSTEM

Hydraulic gear pump with LOAD SENSING priority valve for steering circuit. 2-section modular control valve with main relief valve. Double-acting hydraulic cylinders. Hydraulic oil cooling radiator. Full-flow oil filter on the return circuit. Single control cloche-lever with 4-position bucket lifting system and 3-position auxiliary control system.

Max flow	lt/1'	60
Loader relief valve pressure	bar	230
Steering relief valve pressure	bar	190
Lift cylinder	mm	70x937
Bucket cylinder	mm	80x395



### SERVICES CAPACITIES

Engine	lt	8
Front axle	lt	5,8
Rear axle + gear box	lt	6,5
Hydraulic circuit	lt	57
Brake system	lt	1,1
Fuel	lt	70
Water cooling	lt	10



### TECHNICAL FEATURES

Standard bucket capacity	m <sup>3</sup>	0,75
Bucket width	mm	1.700
Straight static tipping load	kg	3.300
Full turned 40° tipping load	kg	3.000
Lifting capacity at max. height	kg	3.100
Dump clearance	mm	3.100
Dump height at 43°	mm	2.450
Reach at 43°	mm	650
Breakout force	kg	5.300



### DIMENSIONS AND WEIGHT

Max lenght in transfer position	mm	4.800
Max width in transfer position	mm	1.700
Max height	mm	2.460
Track width	mm	1.320
Overall tyre width	mm	1.640
Wheel base	mm	1.950
Ground clearance	mm	370
Standard operating weight	kg	4.350
Max permissible weight	kg	4.800

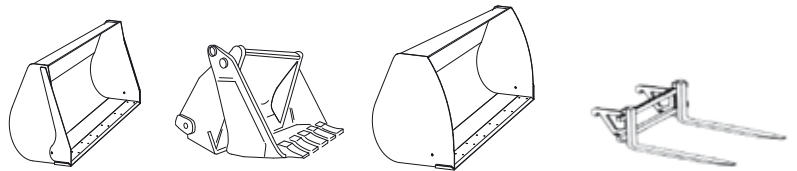
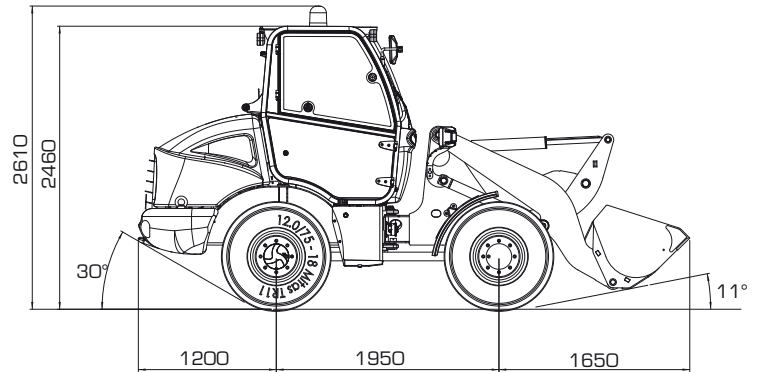
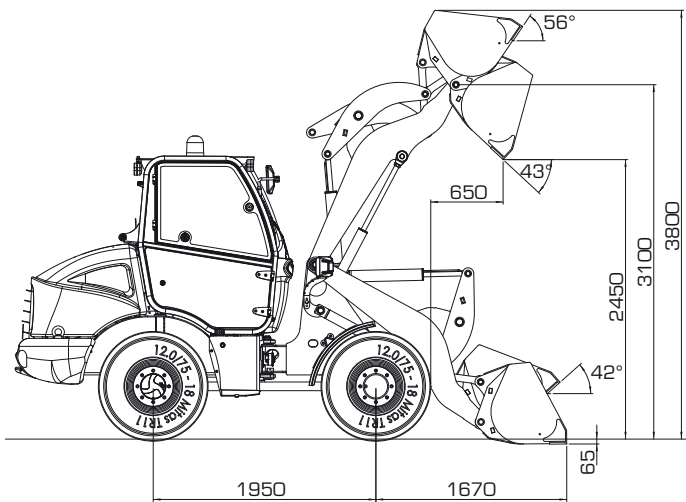

### PERFORMANCE DATA

		UNIVERSAL BUCKET	MULTI PURPOSE BUCKET	OVERSIZE	FORKS
Full load bucket capacity (SAE)	m <sup>3</sup>	0,75	0,6	1,2	/
Bucket width	mm	1.700	1.700	1.900	/
Bucket weight	kg	250	350	350	/
Max operative height	mm	3.800	3.750	3.850	/
Forks lengthh (Standard)	mm				1.000
Forks lengthh (Optional)	mm				1.200
Height to hinge pin	mm	3.100	3.100	3.100	/
Dump angle	°	43°	43°	43°	/
Dump height	mm	2.450	2.500	2.400	/
Reach fully raised	mm	650	600	700	/
Max dump distance	mm	1.450	1.400	1.500	/
Bucket static tipping load, straight	kg	3.300	3.200	2.900	/
Bucket static tipping load, full turn (40°)	kg	3.000	2.900	2.700	/
Forks static tipping load, full turn (40°)	kg				2.400
Forks Payload EN 474-3 (80%)	kg				1.920
Forks Payload EN 474-3 (60%)	kg				1.440
Breakout force	kg	5.400	5.800	5.100	/
Total lengthh	mm	4.800	4.750	4.800	/
External bucket turning radius	mm	4.200	4.000	4.300	/
Standard operative weight	kg	4.350	4.700	4.700	/

### TRANSMISSION

% Traction/Weight	71 %
Pump	500 bar
Hydrostatic engine	500 bar



## EQUIPMENT

2.63D *Plus*

› Acoustic warnings	•
› Plugs with keys for fuel and hydraulic tanks	•
› Bucket with bolted teeth	•
› ROPS-FOPS cab with heating and pressurization fan, with front and rear windscreen wiper and windshield washer	•
› Tool box	•
› Spare parts catalogue	•
› Seat belt	•
› Electrically driven 100% blocking slip differential on front axle	•
› Safety clamp for lifting cylinders	•
› Visual index for bucket position	•
› Working lights	•
› Draw bar hook	•
› Soundproofing	•
› Yellow rotating and overturning beacon	•
› Operation and maintenance manual	•
› Type-approval for road traffic	•
› Side rearview mirrors	•
› Complete instrument panel	•
› Hydraulic or mechanical quick couple	0
› Cement mixing bucket	0
› Benna multiuso 4 in 1	0
› Speed reduction kit	0
› Lifting forks	0
› Proportional self lock rear differential	-
› Electrically driven 100% blocking slip differential on front axle; open on rear axle	-
› Asphalt and cement planer	0
› Snow blower	0
› "V" type snow blade	0
› Angle-tilt dozer blade	0
› Hand operating hammer	0
› Polishing brush	0
› Trencher	0

• Standard    Optional   - Not available



**VENIERI** SPA  
EARTHMOVING MACHINES

Via Piratello, 106 - 48022 Lugo (RA) ITALY  
Tel. +39 0545 904411 Fax +39 0545 30389  
e-mail: info@vf-venieri.com [www.vf-venieri.com](http://www.vf-venieri.com)

### Spare Parts

Tel. +39 0545 904429 Fax +39 0545 24555  
e-mail: ricambi@vf-venieri.com