



SOLID
TO SUCCEED

XC998

F O R K L I F T L O A D E R



Operating Weight	36500 kg
Engine Rated Power	265 kW
Rated Load	24700 kg

The XC998 forklift loader is a globally advanced product developed by the XCMG large-tonnage international research and development platform specifically for stone transfer. This model is powerful, reliable, comfortable and easy to maintain, making it ideal for stone forklift stacking and other working conditions. It is the optimal choice of production and transfer equipment for major quarries.



EFFICIENCY

The EFI, turbo, air-to-air inter-cooled engine, electric start, and electric shutdown with a three-stage air filter and multi-stage fuel filtration system have the advantages of high reliability, high adaptability, low fuel consumption, and low emissions.



SAFETY

The load-sensitive full-variable hydraulic system and flow amplification steering system ensure flexible operation. The dual steering limits contain hard (mechanical) and soft (hydraulic) limits, which can reduce the steering impact and enhance the machine's reliability.



PERFORMANCE

The machine features a scientifically designed structure with the loading gravity center located near the front wheel for balanced load-bearing performance. Key structural components utilize an integrated cube-type design to support heavy-duty forklift operations.



RELIABILITY

The automatic and manual integrated transmission effectively improves working efficiency and economy. The ZF wet drive axle and the key block "three-section" transmission shaft have strong impact resistance and high reliability of power transmission.



PERFORMANCE

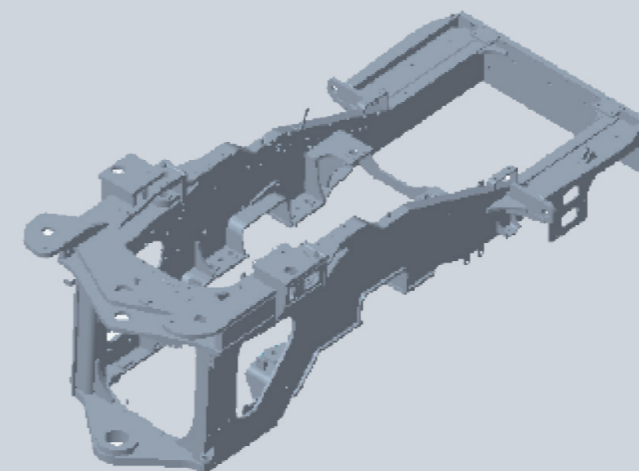

- Structural components improved by finite element analysis demonstrate strong overload resistance and can endure repeated torque and impact in turning.
- Key structural components utilize an integrated cube-type design to support heavy-duty forklift operations.
- Electrostatic powder coating and specialized anti-corrosion technology effectively solve rusting and corrosion.

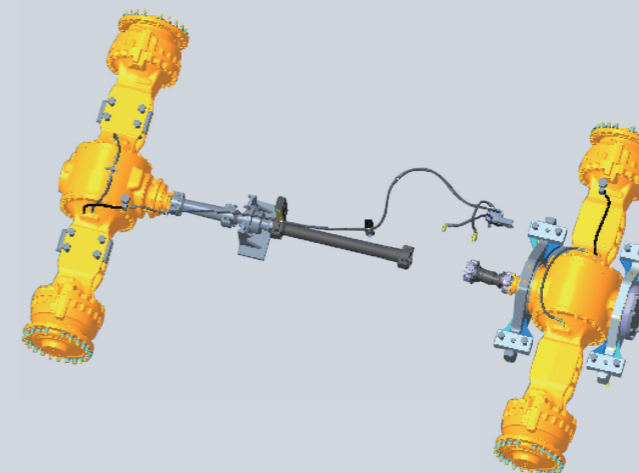

- The ZF wet drive axle features a front axle with a differential locking function and a rear axle with center oscillation, which minimizes the impact of additional torque and external loads on the transmission system.
- The key block “three-section” transmission shaft has strong impact resistance and provides great power transmission.



- Double-tapered roller bearings are utilized to enhance loading capacity and driving stability.
- The Z-type reversing six-linkage structure features dual rocker arm and short pull bar, providing high visibility.
- The enlarged lifting cylinder provides a strong lifting force and allows for smooth lifting.

EFFICIENCY

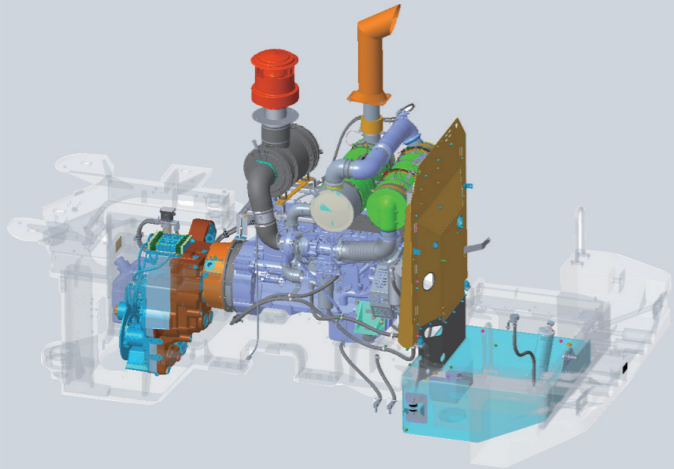

- The EFI, turbo, air-to-air inter-cooled engine, electric start, electric shutdown with a three-stage air filter and multi-stage fuel filtration system can be adapted to dusty working conditions.
- The automatic and manual integrated transmission (F3/R4) has KD gear, ICCO, neutral start protection and variable-speed gear locking function.
- Enhanced power matching technology ensures optimal power performance and meets full-load hill-climbing requirements.

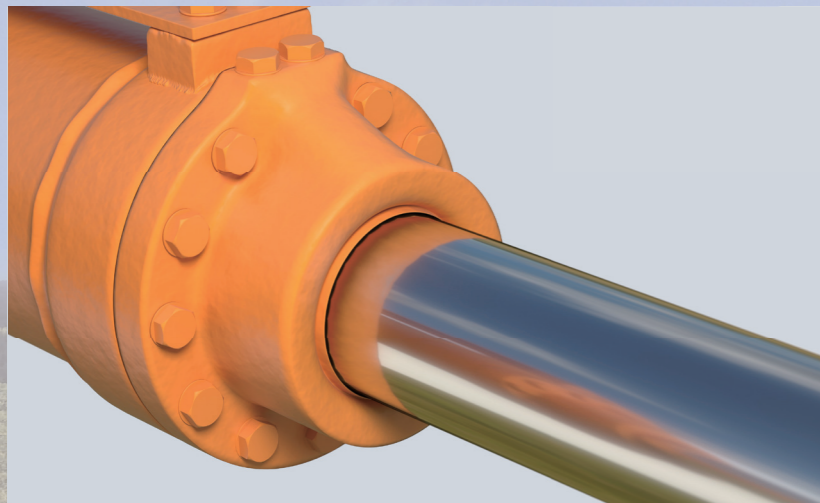

- The load-sensitive full-variable hydraulic system provides pressure and flow according to the needs of the machine to eliminate overflow loss and significantly improve fuel and work efficiency.
- Flow amplification steering system for flexible operation.
- The dual-pump convergence technology significantly enhances working efficiency.



- The low-pressure wide-based off-road tires with low rolling resistance effectively reduce tire wear. The rear axle with center oscillation features remarkable off-road and passing performance, enabling our loader to drive and operate on rough roads.



SAFETY AND COMFORT



- Boom is made of high-strength plate with a large safety coefficient.
- The loading gravity center is close to the front wheels for balanced load-bearing performance and reliable operation.

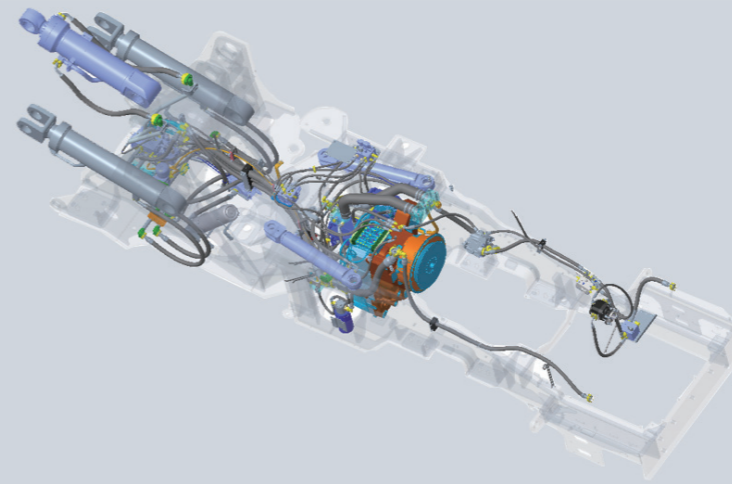

- Hydraulic dual-circuit wet service brake, caliper disc parking brake, and front and rear axle brakes are independent of each other and have low-pressure alarm protection. The emergency brake and parking brake are integrated to ensure operation safety.
- The rear-view camera provides the operator with a wider rearview, ensuring reliable operation.



- FOPS&ROPS pressurized cab offers ample space and effective sealing.
- Integral glass structure on both sides of the front minimizes visual obstruction and enhances the field of view.
- Airbag-damped seats, dampers and other core components ensure operating comfort.
- Intelligent temperature-controlled high-power air conditioner offers comfortable environment.

MAINTENANCE



- Fully back-flipped hood for easy maintenance of engine oil, diesel fuel, and other filter element replacement.
- The large-pitch single-layer radiator and rotatable air conditioning radiator simplify the process of clearing clogs in the radiator.
- The electrical fuse box is centrally located for convenient maintenance and assessment of the operational status of electrical components.

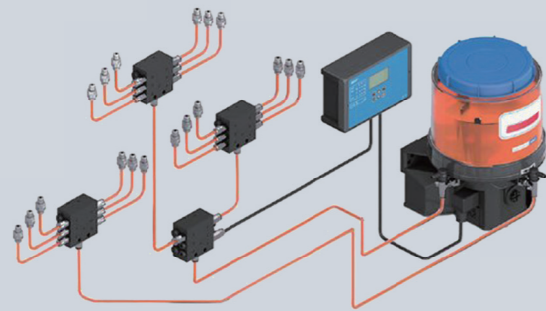

- Standard centralized lubrication system, improving lubrication efficiency. Centralized repair point design for convenient maintenance.
- The automatic controller features a timer that ensures the CPU automatically saves data when the machine halts to prevent insufficient lubrication.
- The injection cycle and oiling time can both be adjusted using the control panel of the pump.
- Centralized pressure measurement and liquid discharge functions are designed for easier daily maintenance.



- GPS enables remote data diagnostics, allowing real-time monitoring of various technical parameters and operating conditions, which provides data support for maintenance.
- The implementation of the “full lifecycle” program provides global coverage of marketing and service outlets, ensuring exceptional support.



MAIN SPECIFICATIONS

Overall Parameter

Model	Parameter
Operating Weight	36500 kg
Rated Load	24700 kg
Tipping Load	Straight≥27500 kg

Engine

Manufacturer/Model	CUMMINS/X12
Type	In-line six-cylinder, air-to-air intercooler, electronic common rail high-pressure injection
Rated Power	265 kW/2000 rpm
Max Power	283 kW/1700 rpm
Max Torque	1862 N.m/1400 rpm
Emission Stage	T4f/ EU stageV
Displacement	11.8 L

Driveline

Transmission	Type	Automatic transmission	
Travel speed	Forward	1 st	6.5 km/h
		2 nd	11.5 km/h
		3 rd	24.5 km/h
		4 th	33 km/h
	Reverse	1 st	6.5 km/h
		2 nd	11.5 km/h
3 rd		24.9 km/h	
Brake Distance	≤14 m		
Tyre	29.5R25		
Min Ground Clearance	480 mm		

Axle

Type	Four-wheel drive
Front Axle	Fixed
Rear Axle	Center oscillation/with 11.5° oscillating angle to each side
Reduction gear	Planetary final drive in wheel hubs
Differential	Front axle limited-slip differential

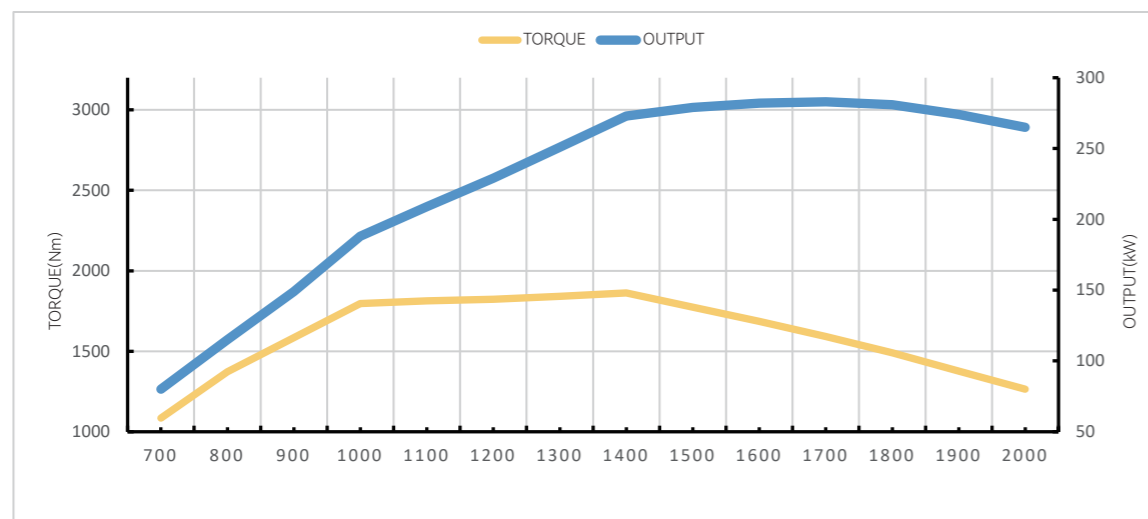

Engine External Characteristic Curve

Cab

Cab	ROPS & FOPS cab is equipped with front sun visor, rear-view mirror, extinguisher, breaker, clothes hook; Adjustable steering column, mechanically suspended damping seat and
Heating Power	≥5.5 kW
Cooling Power	≥8.0 kW

Brake

Service Brake	Dual circuit independent wet hydraulic brake system ensure safe operation.
Parking Brake	Electric control caliper disc brake
Emergency Brake	Parking brake and emergency brake are combined. The emergency stop button on the inside and outside help stop the engine in an emergency.

Hydraulic System

Type	Full variable
Pump	Variable displacement piston pump
Rated Flow	500 L/min
Control Valve	Standard hydraulic control multiway valve
System Pressure	28 MPa
Operating Hydraulic Circuit	Lifting circuit for lifting, holding, lowering and staying movable status of the boom Tipping cylinder circuit for returning, holding and tipping the bucket
Total Circle Time	≤15.5 s
Hydraulic Cylinder	Lifting Cylinder-2-200×110-962.5 mm Tipping Bucket Cylinder-2-170×100-653 mm

Steering System

Type	Flow amplifier load-sensitive steering system
Pump	Variable displacement piston pump
Rated Flow	200 L/min
Hydraulic Cylinder	2
System Pressure	21 MPa
Max Steering Angle	38±2°

Sound

Sound Pressure Level (ISO 6396:2008)	75 dB
Exterior Sound Power Level (ISO 6395:2008)	108 dB

* The guaranteed sound levels described below may vary depending on factors including operating conditions, cooling fan speeds, engine type, and so on. Hearing protection is required if the operator works in an improperly maintained cab or is exposed to noisy environments with open doors or windows.

Referenced Filling Capacity

*Reference only. Filling volume is based on the actual scale.

Item	Filling Capacity
Diesel	430 L
Engine Oil	34 L
AdBlue	51 L
Front Axle	66 L
Rear Axle	66 L
Transmission	64 L
Coolant	62 L
Hydraulic Oil	160 L

MAIN SPECIFICATIONS

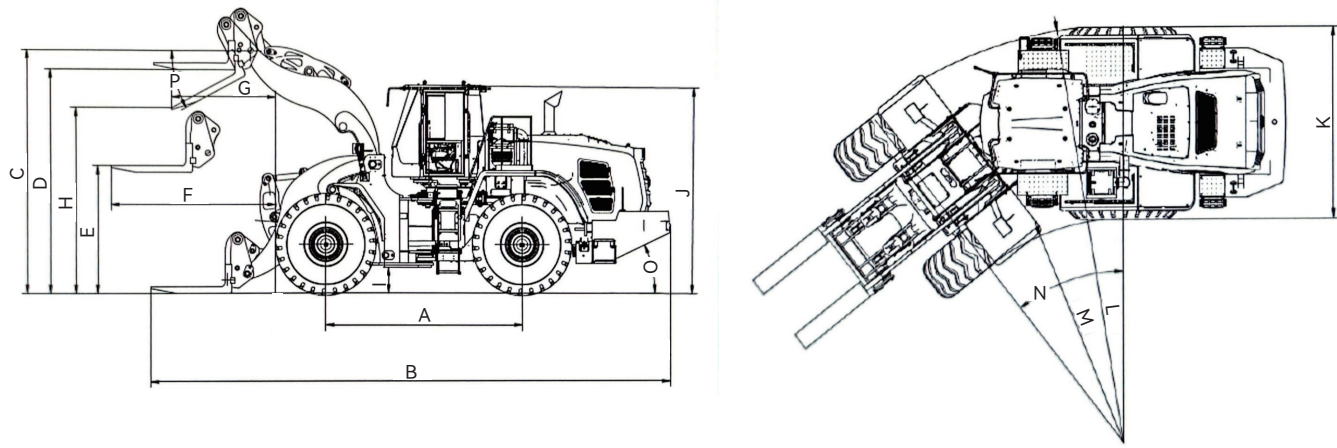

	Dimension and Specification	Parameter
A	Wheel base	3700mm
B	Overall Length	9800mm
C	Height: Bucket Pin	4440mm
D	Maximum Lifting Height	4310mm
E	lift height at boom leveling	2330mm
F	distance: bracket to tyres	3260mm
G	dumping reach at max lifting	1940mm
H	dumping height at max lifting	2945mm
I	Height: Ground Clearance	480mm
J	Overall Length	3870mm
K	Overall width	3350mm
L	Turning radius: outside of tyre	7050mm
M	Turning radius: inside of tyre	3730mm
N	Steering angle	38°
O	Departure Angle	25°
P	Dump Angle	28°

• The technology of XCMG wheel loaders is subject to constant improvement and upgrading. In case the specifications or detailed appearance contained in this brochure differ from actual products, the latter shall prevail.

• XCMG reserves the right of final interpretation for the above. Our products may be modified without prior notice to users.

EQUIPMENT

Powertrain	STD	OPT
CUMMINS Engine	●	
Engine intake preheating	●	
Transmission F4/R3	●	
Manual/automatic shift	●	
Hydraulic torque converter	●	
Front axle differential lock	●	
Parking brake	●	
Service brake (closed wet disc)	●	
Power cutoff	●	
Emergency stop	●	
Transmission oil level indicator	●	
Engine oil level indicator	●	
29.5R25 radial tyre	●	
Techking 29.5R25 tyre		●
Michelin 29.5R25 L5 tyre		●

Electrical system	STD	OPT
Electrical air cleaner blockage alert	●	
LED front combined lights (High beams, low beams, clearance light, steering light)	●	
LED low beams	●	
4 Front LED working light	●	
2 Rear LED working light	●	
2 Rear hood LED working light	●	
2 Rear combined light lights (Reserve, turn signal, clearance light, brake lights)	●	
LED cab light	●	
LED rotating warning light	●	
10.1 inch screen	●	
Bluetooth radio	●	
Weigh system		●
Rearview camera	●	
Silicone button	●	
Rocker switch	●	
USB electrical access	●	
12V electrical access	●	
24V electrical access	●	
Screen display		
Transmission oil temperature	●	
Engine coolant temperature	●	
Fuel level	●	
Engine tachometer	●	
Brake pressure	●	
Engine oil pressure	●	
Transmission malfunction code	●	
Engine malfunction code	●	
Battery voltage	●	
Working hour display	●	
Parking brake	●	
Engine status indicator light	●	
Gear information	●	

Hydraulic System	STD	OPT
Hydraulic oil blockage alert	●	
Emergency steering	●	
Variable independent heat dissipation	●	
Brake low pressure alarm	●	
Centralized pressure measurement	●	
Anti-explosion valve		●
Ride control		●
Hydraulic oil temperature measurement		●

Cab	STD	OPT
Front/rear wiper	●	
Rearview mirror	●	
ROPS/FOPS cab	●	
Radio/USB player	●	
Adjustable steering wheel	●	
Sun visor(front)	●	
Clothes hook	●	
Magazine bag	●	
Left/right armrest	●	
Retractable safety belt	●	
Tinted safety glass	●	
24V to 12V Dc converter(10A)	●	
Suspended seat	●	
Cab lock/ key	●	
Single brake pedal	●	
Start-up	●	
FNR gear	●	
Cooling and heating air-conditioner	●	
Cup holder	●	
Dual brake pedal		●
Rearview mirror preheating		●
RESPA pressurized filter system		●
Protective screen		●
Sun visor(rear)		●

Safety	STD	OPT
360° panoramic image	●	
Handheld fire extinguisher		●
Boom safe lever	●	
Emergency steering	●	
Automatic flameout parking	●	

Other	STD	OPT
Weigh system	●	
Traction pin	●	
Handrails/ladders/ platforms/pedals	●	
Splash guard (front/rear)	●	
Chassis guard (engine, transmission)	●	
Anti-corrosion spray		●
Toolkit	●	
Reversible fan	●	
Auto-lubrication (progressive type)	●	

OPTIMUM SERVICES XCMG GUARANTEED



Telematic information Processing

Remote Diagnosis. GPS terminal system monitors the construction state of the machine and the operating.

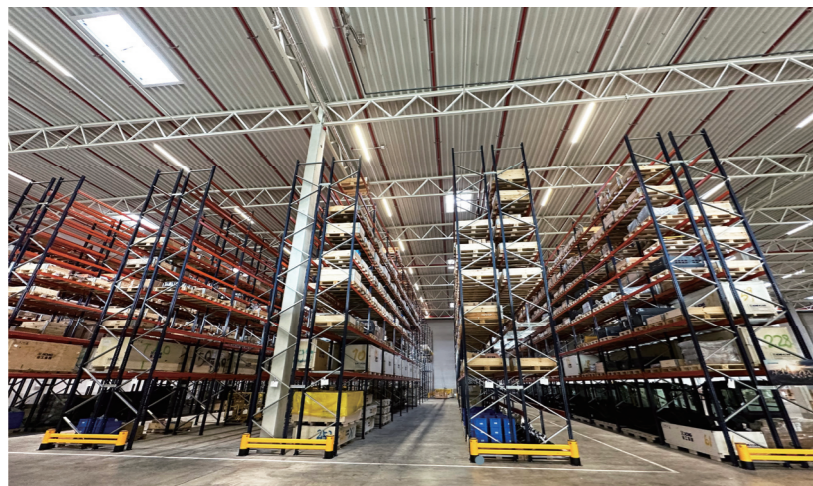

Professional Integrated Complete Solutions

XCMG has built a strong reputation based on the quality, reliability and durability of its construction machinery. What's more, XCMG has gradually established a service network to constantly provide its local integrated and highly efficient complete solutions for all customers.

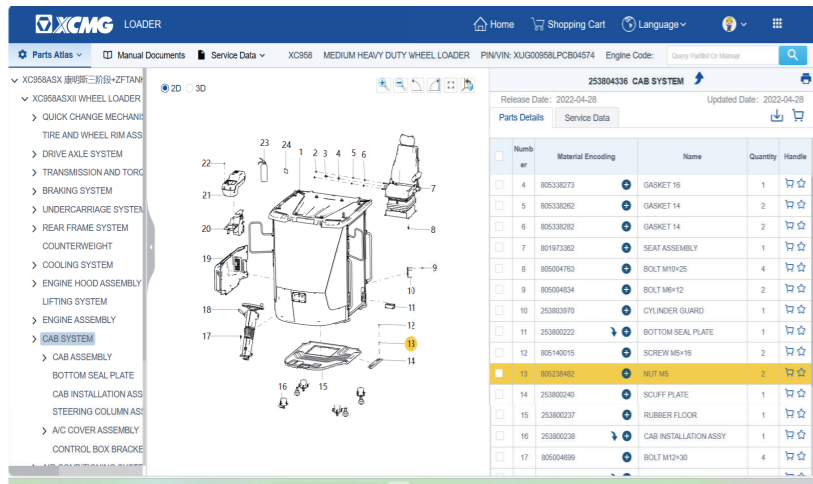

Full Range of Services Ready for you

In order to respond to your needs as fast as possible, XCMG's experts are on their way to your job site from one of our facilities near you. Full range of services are available in order to reduce your total cost of ownership and increase your revenue.



Plateau Construction



Forestry Construction



Animal Husbandry



Road Construction



Stone Mining



Extreme Cold Working Condition



Mine Engineering



Grain Shoveling

INTRODUCTION

Our Mission and Vision: Empower Solid Future.

XCMG was initially founded as the Huaxing Iron Factory in 1943 and was established as a group in 1989. Being a trailblazer walking through the hard days in astern and steady manner, XCMG has taken the lead in development of Chinese construction machinery industry and become a billion-dollar leading enterprises with global competitiveness and influence. XCMG's performance retained its NO.1 position in China construction machinery industry and has achieved the ranking of NO.3 in the Global construction machinery industry for 3 consecutive years and has been listed in the "World Brand 500" for 4 consecutive years.

XCMG Earthmoving Machinery Division is one of the five major business divisions of XCMG. We are professionally dedicated in the R&D, manufacturing, sale and supporting service of 0.6-35tons full-series loaders, skid-steer loaders and backhoe loaders. In line with the business philosophy of facing the world, integrating the world and serving the world, XCMG Earthmoving Machinery Division takes the leading position in quality and value, and become the new benchmark in the high-end market of China earthmoving machinery industry.

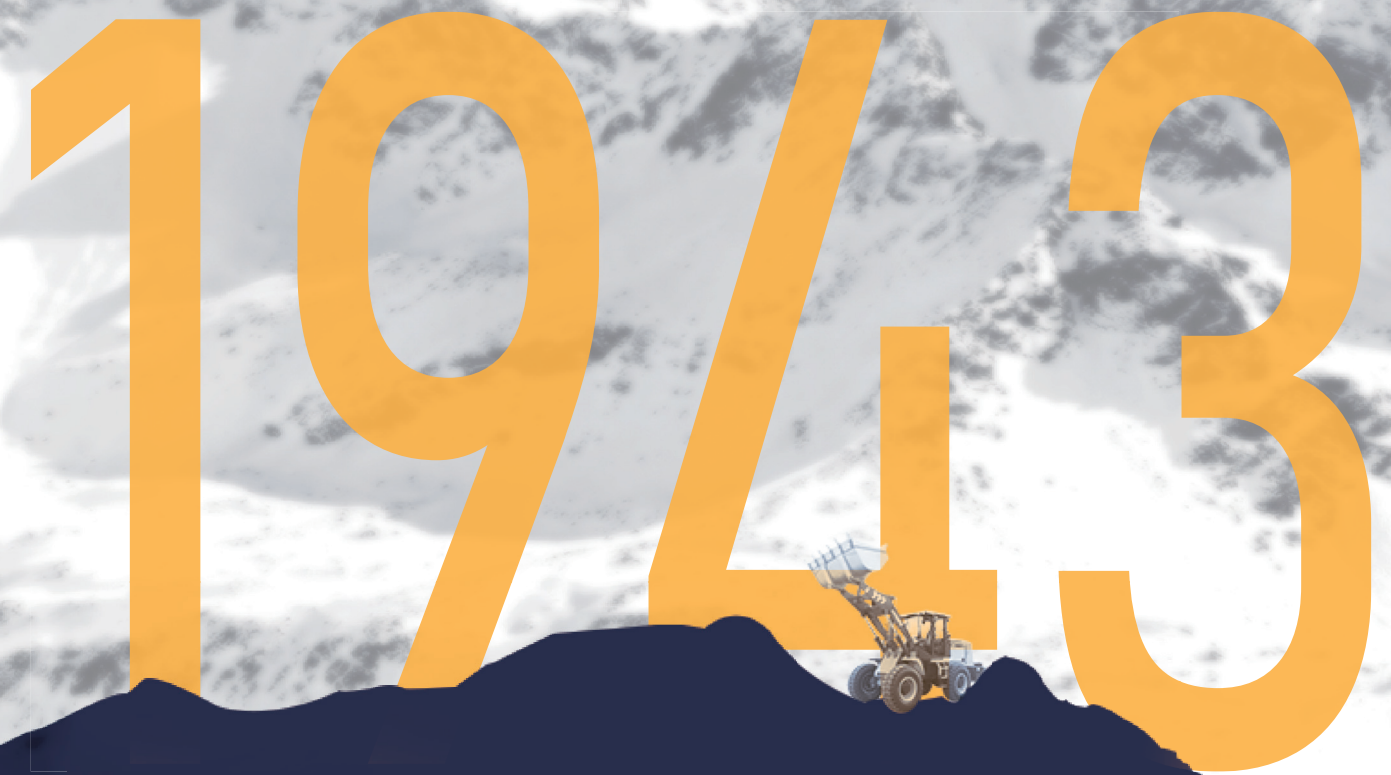

1943

TOP 3

TOP 3 Global Construction Industry

2000

More than 2000 Service Terminals

8500

More than 8500 Valid Patents

40

More than \$4 Billion Annual Exports