

# Venieri 4.63G

## WHEEL LOADER ▶ “Z” LINKAGE

### ▶ DIESEL ENGINE

Engine: 4 cylinder, direct injection diesel engine, water cooled, paper dry filter. Emissioned according to CEE 97/68 stage IIIA.

Type	YANMAR 4TNV98
Max power	54 kW - 73 HP
Rated rpm	2.500
Net power ISO/TR 14396	52 kW - 71 HP
Net power EEC/80/1269	52 kW - 71 HP
Bore	98 mm
Stroke	110 mm
Displacement	3.319 cm <sup>3</sup>

### ▶ ELECTRIC SYSTEM

Battery	12 Volt
Capacity EN 60095-1	100 Ah - 1080 A
Alternator rating	90 A
Reverse warning	Standard
Wiring according with	IP 67 e DIN 40050

### ▶ TRANSMISSION

Hydrostatic transmission with automatic power regulation and closed circuit with variable displacement pump and motor. Two forward/reverse speeds with single lever control.

	FORWARD	REVERSE
1 <sup>st</sup> Gear Km/h	0 - 7	0 - 7
2 <sup>nd</sup> Gear Km/h	0 - 30	0 - 30

Automatic second gear on request.

### ▶ AXLES

Two heavy duty equal size axles with planetary final drives in each wheel. Fixed rigid drive axle on front chassis section. Oscillation drive axle on rear chassis section up to a total angle of 25°. Transfer gearbox transferring movement directly to the rear and to the front axle via a transmission shaft. Self locking limited slip differential on front axle. Self locking limited slip differential on rear axle (optional)

### ▶ BRAKES

Service: hydraulic multi-disc oil brake on front axle working on all the wheels.  
Parking: mechanical brake operating on the service brake, manually actuated.

### ▶ TYRES

Standard	16/70 - 20
Option	405/70 R20 14.5-20

### ▶ STEERING

Servo-assisted steering **LOAD SENSING** system.

Total steering angle	80°
Inner tyres turning radius	2.350 mm
Outer tyres turning radius	4.210 mm
Outer bucket turning radius	4.730 mm



### ▶ HYDRAULIC SYSTEM

Hydraulic gear pump with LOAD SENSING priority valve for the steering circuit. Modular two-element control valve with main relief valve. Double acting hydraulic cylinders. Hydraulic oil cooling radiator. Full-flow oil filter on the leakage pipe. Single servo-lever arm control with 4 position lifting system and with 3 position bucket system.

Max flow	68 lt/1'
Max flow with High Flow (optional)	100 lt/1'
Loader relief valve pressure	230 bar
Steering relief valve pressure	190 bar
Lift cylinders	80 x 585
Bucket cylinder	85 x 395

### ▶ SERVICES CAPACITIES

Engine	11 lt
Gearbox	2 lt
Differential	3,5 lt
Planetary final drive	2 lt
Hydraulic circuit	45 lt
Brake system	1 lt
Fuel	75 lt
Water cooling	15 lt

### ▶ TECHNICAL FEATURES

Standard bucket capacity	1,0 m <sup>3</sup>
Bucket width	2.000 mm
Static tipping load straight	3.900 kg
Static tipping load full turn 40°	3.500 kg
Lifting capacity at max height	3.900 kg
Dump clearance	3.260 mm
Dump height at 41°	2.550 mm
Reach at 41°	800 mm
Breakout force	5.600 kg

### ▶ DIMENSIONS AND WEIGHT

Max. length in transfer position	5.250 mm
Max. width in transfer position	2.000 mm
Max. height	2.750 mm
Track width	1.500 mm
Overall tyre width	1.860 mm
Wheel base	2.150 mm
Ground clearance	380 mm
Standard operating weight	5.400 kg
Max operating weight	5.600 kg

The illustrations on the present folder do not necessarily show the product standard version. Data and dimensions described in this folder are not binding. Venieri reserves the right of carrying out possible changes at any time and without previous notice because of its policy of steady development and improvement of the products.



# Venieri 4.63G

## WHEEL LOADER ▶ "Z" LINKAGE

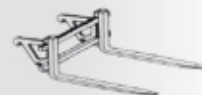
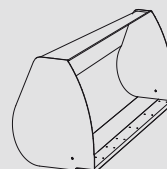
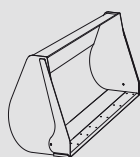
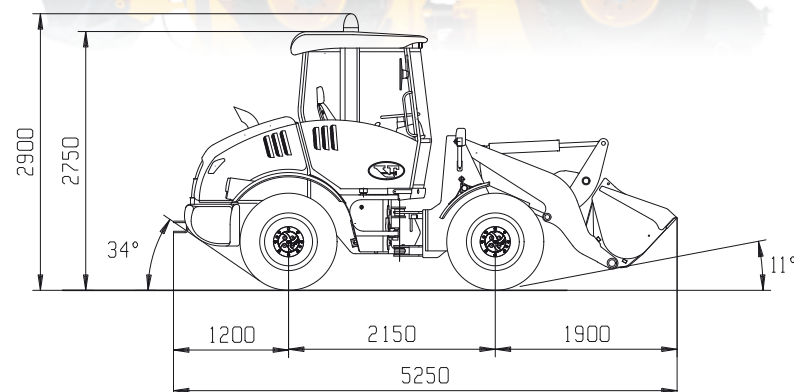
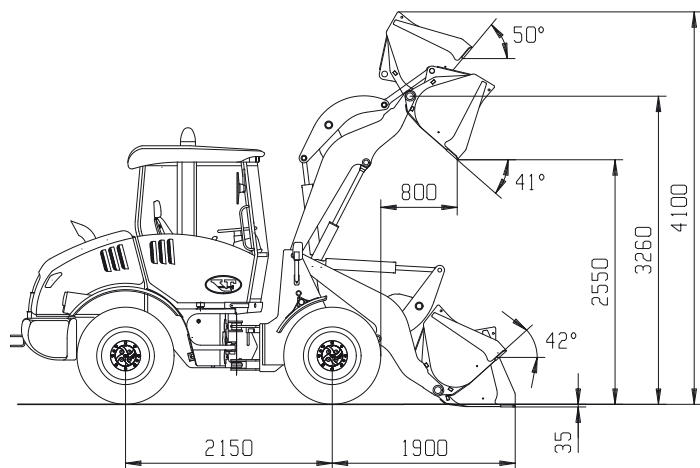

### ▶ PERFORMANCE DATA

		UNIVERSAL BUCKET	MULTI PURPOSE BUCKET	OVERSIZE	FORKS
Full load bucket capacity (SAE)	m <sup>3</sup>	1,0	0,8	1,7	/
Bucket width	mm	2.000	2.000	2.200	/
Bucket weight	kg	350	450	450	/
Max operative height	mm	4.100	4.050	4.150	/
Forks length (Standard)	mm				1.000
Forks length (optional)	mm				1.200
Bucket pin height	mm	3.260	3.260	3.260	/
Dump clearance	mm	41°	41°	41°	/
Dump height	mm	2.550	2.525	2.500	/
Dump distance	mm	800	775	850	/
Max dump distance	mm	1.550	1.500	1.600	/
Bucket static tipping load, straight	kg	3.900	4.150	3.700	/
Bucket static tipping load, full turn (40°)	kg	3.500	3.750	3.300	/
Forks static tipping load, full turn (40°)	kg				2.900
Forks Payload EN 474-3 (80%)	kg				2.300
Forks Payload EN 474-3 (60%)	kg				1.750
Breakout force	kg	5.600	6.000	5.300	/
Total length	mm	5.250	5.200	5.300	/
External bucket turning radius	mm	4.730	4.680	4.780	/
Total weight	kg	5.400	5.500	5.500	/

UP 518A 2013



# Venieri

Via Piratello, 106 - 48022 Lugo(RA) ITALY  
 Tel. +39 0545 904411 Fax +39 0545 30389  
 Spare Parts  
 Tel. (+39) 0545 904429 Fax (+39) 0545 24555  
[www.vf-venieri.com](http://www.vf-venieri.com)